

4

3

2

1

DO NOT SCALE DRAWING

THE INFORMATION CONTAINED HEREIN IS THE EXCLUSIVE PROPERTY OF VIRGINIA PANEL CORPORATION AND IS SUBMITTED FOR USE BY THE CUSTOMER ONLY. THE DATA SHALL NOT BE DUPLICATED, USED, OR DISCLOSED IN WHOLE OR IN PART FOR ANY PURPOSE OTHER THAN TO MAINTAIN THE EQUIPMENT PROVIDED. CONSULT WITH VIRGINIA PANEL CORPORATION ENGINEERING IF MORE DETAIL IS REQUIRED.

REVISIONS			
REV	DESCRIPTION	DATE	ENGR
A	ORIGINAL RELEASE - ECN #06-510-0043	4/27/06	TF

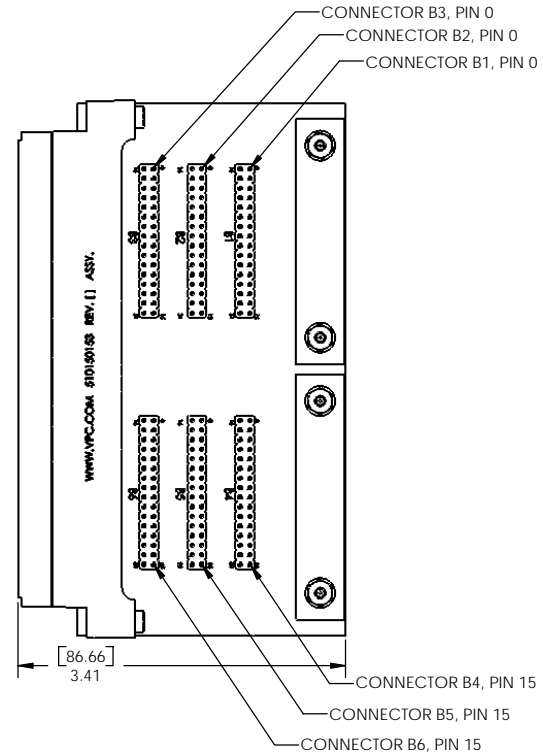
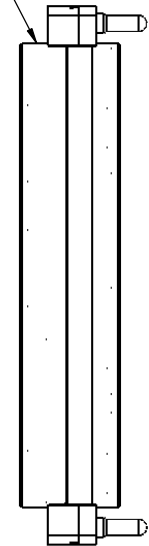
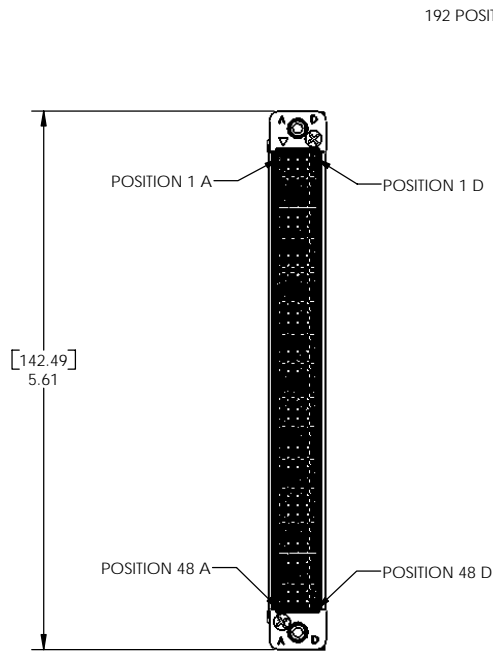

6. TECHNICAL DATA:
 MATERIAL : BOARD FR4 w/SOLDERMASK
 VPC CONNECTOR BLACK LCP w/GOLD PLATED BERYLIUM COPPER CONTACTS
 BOARD CONNECTOR BLACK LCP w/GOLD PLATED PHOSPHOR BRONZE POSTS
 CURRENT: 2 AMPERE CONTINUOUS @150V RMS

5. ITEMS SHIPPED LOOSE, NOT SHOWN
 (QTY 1) 3/32" BALL END HEX L WRENCH
 (QTY 2) 4-40X.13" THREADED STANDOFF
 (QTY 2) 4-40X1.25" SOCKETHEAD CAP SCREW
 (QTY 2) 4-40X.31" THREADED STANDOFF

4. SIX 32 PIN DOUBLE ENDED RIBBON CABLES, VPC PART # 515 109 162, ARE INCLUDED

3. THIS PCB ADAPTER WAS DESIGNED WITH A LEFT MOUNTED PC BOARD FOR OPTIMAL CABLE MANAGEMENT
 DO NOT MOUNT BESIDE A PCB ADAPTER WITH A RIGHT MOUNTED PC BOARD

2. THIS PCB ADAPTER WILL ACCOMMODATE ONE OR TWO NATIONAL INSTRUMENTS TB-2634 TERMINAL BLOCKS
 USE MATRIX 1 CONNECTORS - B1, B2 AND B3 FOR FIRST TERMINAL BLOCK
 USE MATRIX 2 CONNECTORS - B4, B5 AND B6 FOR SECOND TERMINAL BLOCK

1. FOR APPLICATION USE & CARE INFORMATION CONSULT VPC USERS GUIDE @WWW.VPC.COM
 NOTES:

CUSTOMER DRAWING			
VIRGINIA PANEL CORPORATION WWW.VPC.COM			
PCB ADAPTER, RECEIVER, 192 POSITION QUADRAPADDLE TO NI PXI-2529 WITH SIX 20" CABLES			
DIMENSIONS ARE SHOWN AS: [MILLIMETERS] INCHES	SIZE C	CAGE CODE 18117	DWG. NO. 510150153
SCALE: 1:1	510150153	4/27/06	REV A
SHEET		1 OF 2	

4

3

2

1

SIGNAL TRACES

VPC Module	Connector	VPC Module	Connector	VPC Module	Connector	VPC Module	Connector	VPC Module	Connector	VPC Module	Connector	VPC Module	Connector	VPC Module
A1 >	B2-16	A25 >	B3-24	B1 >	B2-0	B25>	B3-8	C1 >	B1-16	C25>	B6-24	D1 >	B1-0	D25>
A2 >	B2-17	A26 >	NC	B2 >	B2-1	B26>	NC	C2 >	B1-17	C26>	NC	D2 >	B1-1	D26>
A3 >	B2-18	A27 >	B3-26	B3 >	B2-2	B27 >	B3-10	C3 >	B1-18	C27 >	B6-26	D3 >	B1-2	D27 >
A4 >	B2-19	A28 >	NC	B4 >	B2-3	B28 >	NC	C4 >	B1-19	C28 >	NC	D4 >	B1-3	D28 >
A5 >	B2-20	A29 >	B3-28	B5 >	B2-4	B29 >	B3-12	C5 >	B1-20	C29 >	B6-28	D5 >	B1-4	D29 >
A6 >	B2-21	A30 >	NC	B6 >	B2-5	B30 >	NC	C6 >	B1-21	C30 >	NC	D6 >	B1-5	D30 >
A7 >	B2-22	A31 >	B3-30	B7 >	B2-6	B31 >	B3-14	C7 >	B1-22	C31 >	B6-30	D7 >	B1-6	D31 >
A8 >	B2-23	A32 >	NC	B8 >	B2-7	B32 >	NC	C8 >	B1-23	C32 >	NC	D8 >	B1-7	D32 >
A9 >	B2-24	A33 >	B5-16	B9 >	B2-8	B33 >	B5-0	C9 >	B1-24	C33 >	B4-16	D9 >	B1-8	D33 >
A10 >	B2-25	A34 >	B5-17	B10 >	B2-9	B34 >	B5-1	C10 >	B1-25	C34 >	B4-17	D10 >	B1-9	D34 >
A11 >	B2-26	A35 >	B5-18	B11 >	B2-10	B35 >	B5-2	C11 >	B1-26	C35 >	B4-18	D11 >	B1-10	D35 >
A12 >	B2-27	A36 >	B5-19	B12 >	B2-11	B36 >	B5-3	C12 >	B1-27	C36 >	B4-19	D12 >	B1-11	D36 >
A13 >	B2-28	A37 >	B5-20	B13 >	B2-12	B37 >	B5-4	C13 >	B1-28	C37 >	B4-20	D13 >	B1-12	D37 >
A14 >	B2-29	A38 >	B5-21	B14 >	B2-13	B38 >	B5-5	C14 >	B1-29	C38 >	B4-21	D14 >	B1-13	D38 >
A15 >	B2-30	A39 >	B5-22	B15 >	B2-14	B39 >	B5-6	C15 >	B1-30	C39 >	B4-22	D15 >	B1-14	D39 >
A16 >	B2-31	A40 >	B5-23	B16 >	B2-15	B40 >	B5-7	C16 >	B1-31	C40 >	B4-23	D16 >	B1-15	D40 >
A17 >	B3-16	A41 >	B5-24	B17 >	B3-0	B41 >	B5-8	C17 >	B6-16	C41 >	B4-24	D17 >	B6-0	D41 >
A18 >	NC	A42 >	B5-25	B18 >	NC	B42 >	B5-9	C18 >	NC	C42 >	B4-25	D18 >	NC	D42 >
A19 >	B3-18	A43 >	B5-26	B19 >	B3-2	B43 >	B5-10	C19 >	B6-18	C43 >	B4-26	D19 >	B6-2	D43 >
A20 >	NC	A44 >	B5-27	B20 >	NC	B44 >	B5-11	C20 >	NC	C44 >	B4-27	D20 >	NC	D44 >
A21 >	B3-20	A45 >	B5-28	B21 >	B3-4	B45 >	B5-12	C21 >	B6-20	C45 >	B4-28	D21 >	B6-4	D45 >
A22 >	NC	A46 >	B5-29	B22 >	NC	B46 >	B5-13	C22 >	NC	C46 >	B4-29	D22 >	NC	D46 >
A23 >	B3-22	A47 >	B5-30	B23 >	B3-6	B47 >	B5-14	C23 >	B6-22	C47 >	B4-30	D23 >	B6-6	D47 >
A24>	NC	A48 >	B5-31	B24>	NC	B48 >	B5-15	C24>	NC	C48 >	B4-31	D24>	NC	D48 >

NC= NO CONNECT

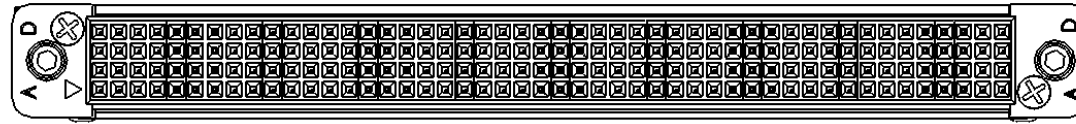

CONNECTOR B1

CONNECTOR B6

CONNECTOR B4

D1-	16	17	18	19	20	21	22	23	24	25	26	27	28	29	30	31	0	1	2	3	0	1	2	3	16	17	18	19	20	21	22	23	24	25	26	27	28	29	30	31	D48
C1+	16	17	18	19	20	21	22	23	24	25	26	27	28	29	30	31	0	1	2	3	0	1	2	3	16	17	18	19	20	21	22	23	24	25	26	27	28	29	30	31	C48
B1-	0	1	2	3	4	5	6	7	8	9	10	11	12	13	14	15	0	1	2	3	0	1	2	3	0	1	2	3	4	5	6	7	8	9	10	11	12	13	14	15	B48
A1+	0	1	2	3	4	5	6	7	8	9	10	11	12	13	14	15	0	1	2	3	0	1	2	3	0	1	2	3	4	5	6	7	8	9	10	11	12	13	14	15	A48

CONNECTOR B2

CONNECTOR B3

CONNECTOR B5

CUSTOMER DRAWING - CUSTOMER DRAWING - CUSTOMER DRAWING

THE INFORMATION CONTAINED HEREIN IS THE EXCLUSIVE PROPERTY OF VIRGINIA PANEL CORPORATION AND IS SUBMITTED FOR USE BY THE CUSTOMER ONLY. THE DATA SHALL NOT BE DUPLICATED, USED, OR DISCLOSED IN WHOLE OR IN PART FOR ANY PURPOSE OTHER THAN TO MAINTAIN THE EQUIPMENT PROVIDED.

SIZE	CAGE CODE	DWG. NO.	REV
C	18117	510150153	A
SCALE: 2:1		510150153	4/27/06
			SHEET 2 OF 2

DO NOT SCALE DRAWING