

DO NOT SCALE DRAWING

THE INFORMATION CONTAINED HEREIN IS THE EXCLUSIVE PROPERTY OF VIRGINIA PANEL CORPORATION AND IS PROVIDED FOR USE BY THE CUSTOMER ONLY.

REVISIONS			
REV	DESCRIPTION	DATE	APPROVED
K	07-610-0006	5/30/07	DMA

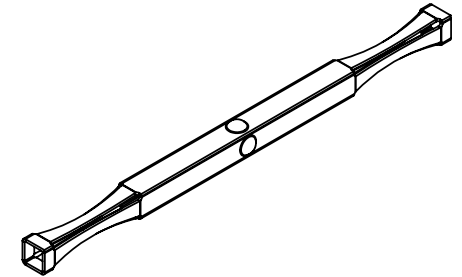
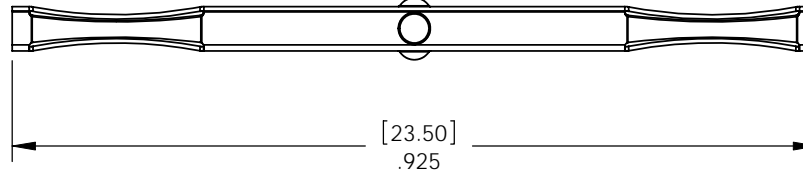

3. THE LENGTH OF THE PINS ON A MATING COMMERCIAL HEADER MUST BE GREATER THEN 0.22" [5.59] AND LESS THEN 0.45" [11.43]

2. PHYSICAL CHARACTERISTICS:
 WEIGHT .0002 LBS
 MATERIALS:
 CONTACT-BERYLLIUM COPPER
 CONTACT PLATING- 50 μ INCHS Au OVER 100 μ INCHES NICKEL

1. FOR APPLICATION USE AND CARE INFORMATION CONSULT VPC USERS MANUAL @ WWW.VPC.COM

NOTES:

CUSTOMER DRAWING - CUSTOMER DRAWING			
DIMENSIONS ARE SHOWN AS [MILLIMETERS] INCHES	DR	D Ashby	5/20/02
	CHK	M Dolfi	5/23/03
MATERIAL Beryllium Copper			
FINISH 50μ inch Gold over 100μ inch Nickel			
SIZE B	FSCM NO. 18117	DWG.NO. 610138100	REV K
SCALE: 5:1	610138100	5/20/02	SHEET 1 OF 1

VIRGINIA PANEL CORP.

DBL FML CNT 4 BEAM W GIMBEL