

4

3

2

1

DO NOT SCALE DRAWING

THE INFORMATION CONTAINED HEREIN IS THE EXCLUSIVE PROPERTY OF VIRGINIA PANEL CORPORATION AND IS SUBMITTED FOR USE BY THE CUSTOMER ONLY. THE DATA SHALL NOT BE DUPLICATED, USED, OR DISCLOSED IN WHOLE OR IN PART FOR ANY PURPOSE OTHER THAN TO MAINTAIN THE EQUIPMENT PROVIDED. CONSULT WITH VIRGINIA PANEL CORPORATION ENGINEERING IF MORE DETAIL IS REQUIRED.

REVISIONS

REV	DESCRIPTION	DATE	ENGR
C	ECN #10651	9/9/2020	J SILER

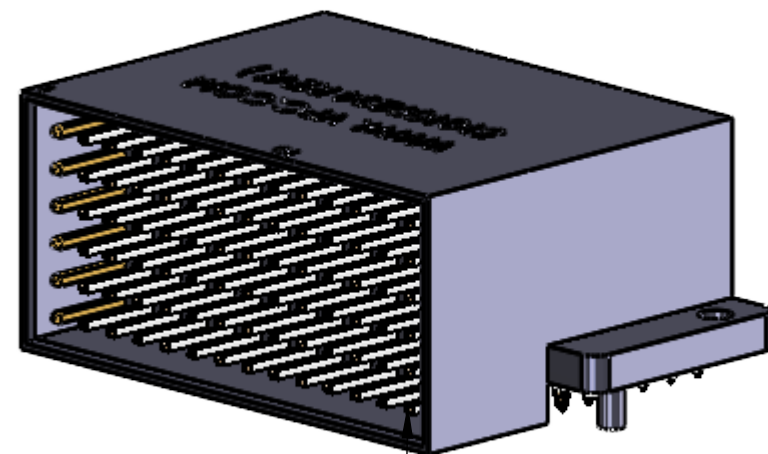
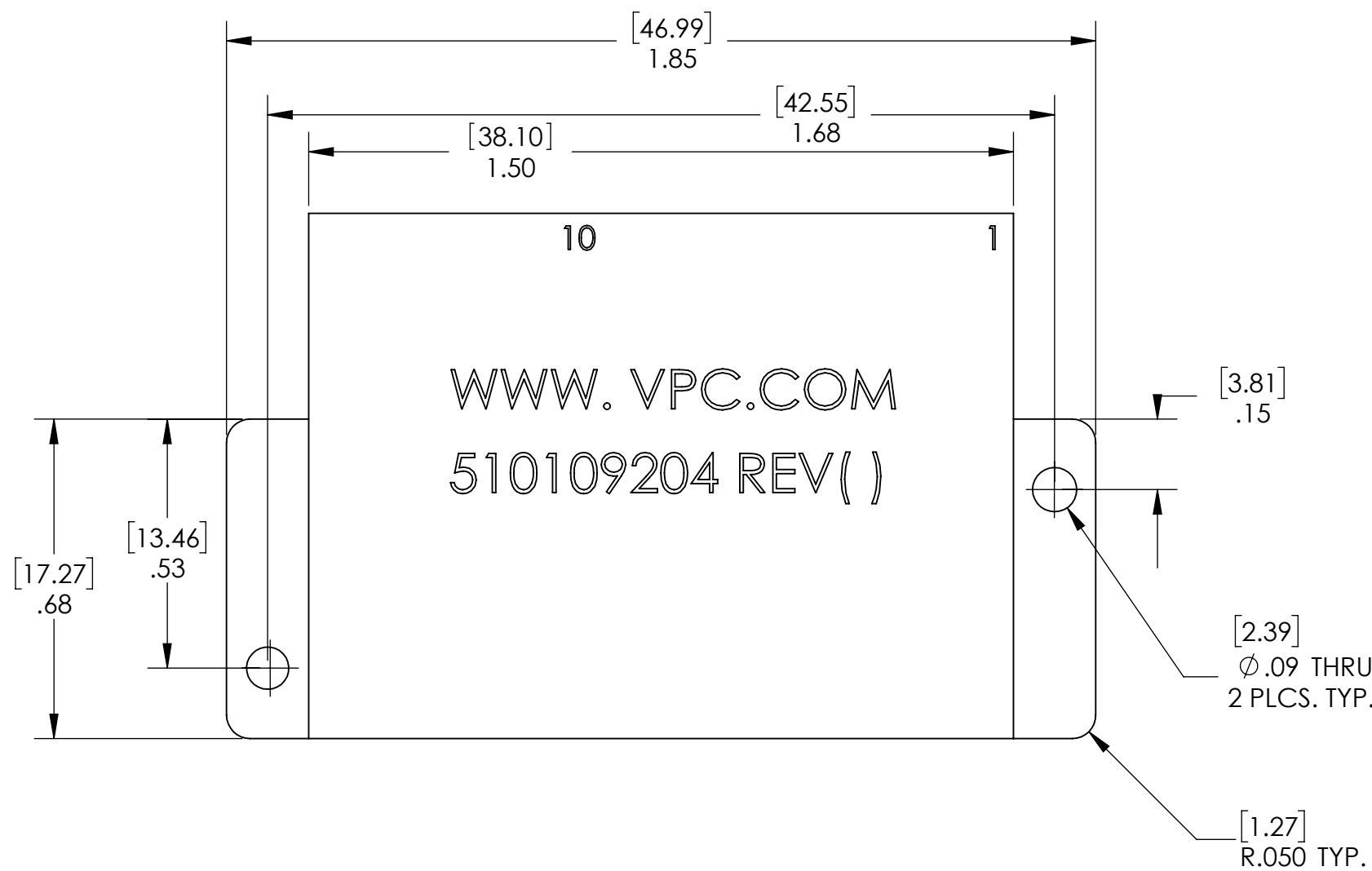

CONTACT PINS .025 [0.64]
SQ. POSTS
GOLD PLATED
SEE NOTE 3.

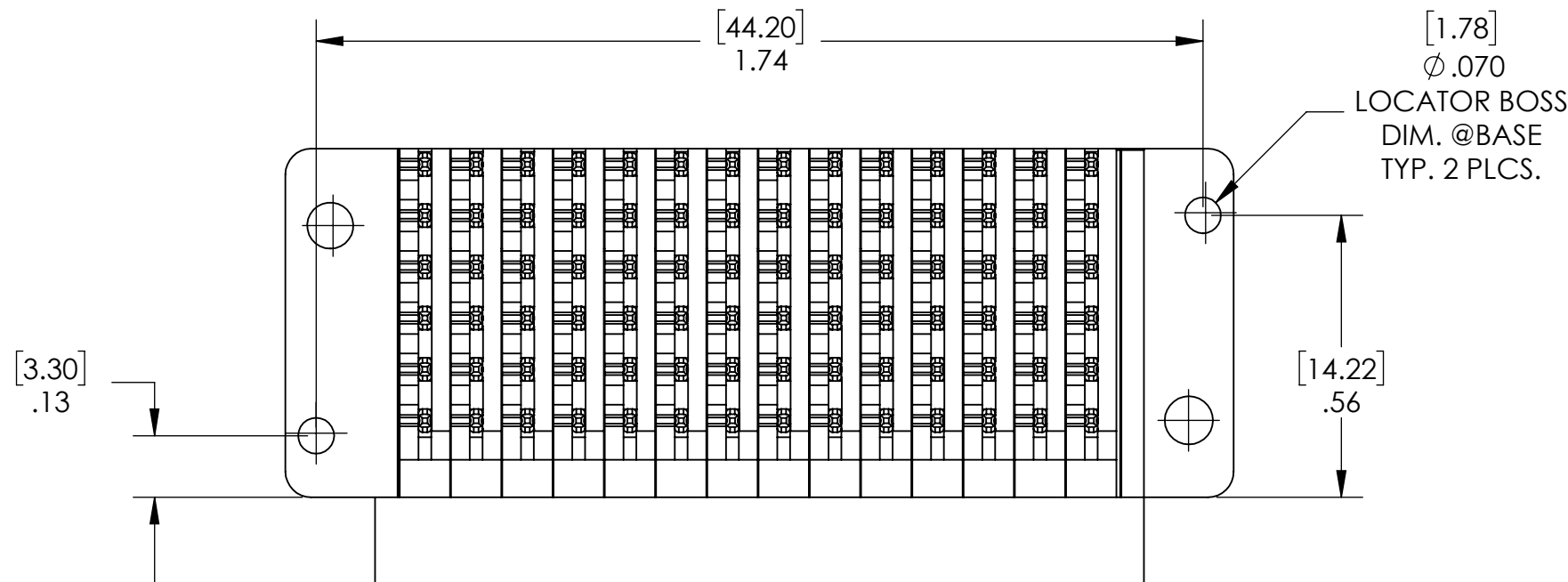
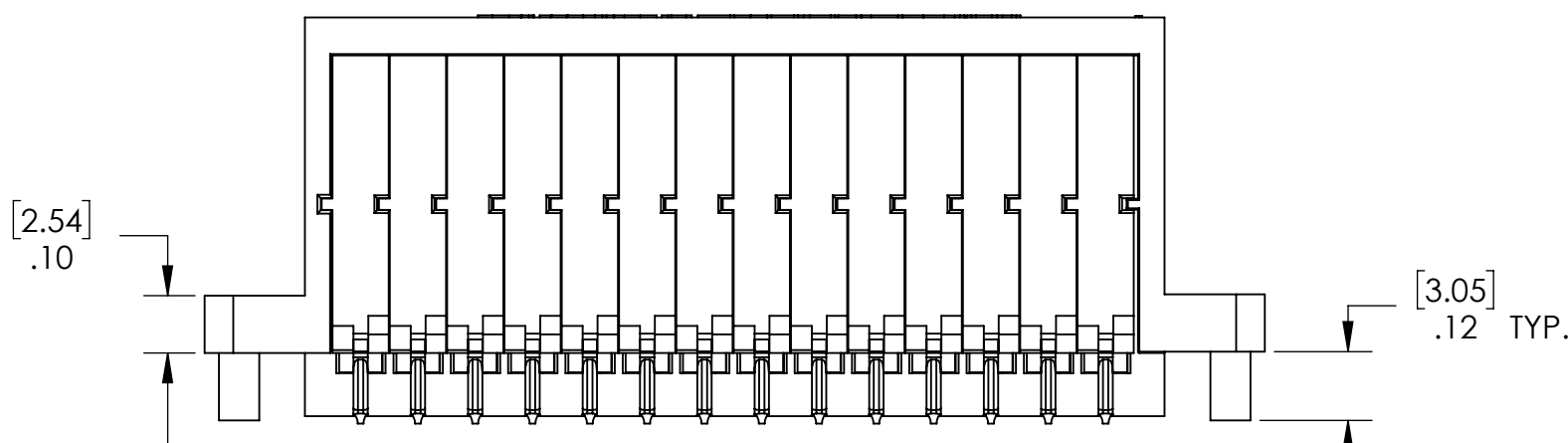
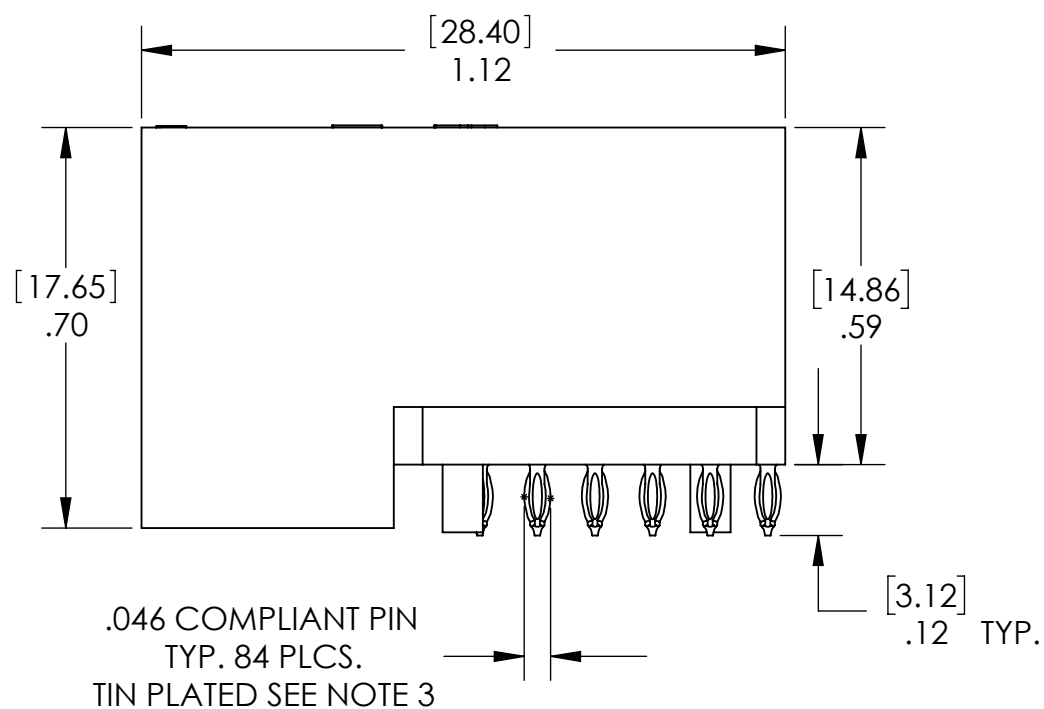

6. SEE SHEET 2 FOR NOTE.
5. SEE SHEET 2 FOR NOTE.
4. CONTINUOUS MAX. CARRY CURRENT 5 AMPS
3. HEADER CONTACT PINS PLATED 30 MIN. MICROINCHES OF GOLD OVER 100 MIN. MICROINCHES OF NICKEL. THE COMPLIANT PINS PLATED 100-200 MICROINCHES OF TIN OVER 50 MIN. MICROINCHES OF NICKEL
2. BAG (2) M2 X 8 PAN HEAD PHILLIPS SCREW & (2) M2 HEX NUTS INCLUDED WITH HEADER
1. FOR APPLICATION USE & CARE INFORMATION CONSULT VPC USERS GUIDE @WWW.VPC.COM
- NOTES:

CUSTOMER DRAWING

VIRGINIA PANEL CORPORATION
WWW.VPC.COM

MODULE HDR 84 POSITION
RT ANG COMP PIN

DIMENSIONS ARE SHOWN AS:	SIZE	CAGE CODE	DWG.NO.	REV
[MILLIMETERS] INCHES	C	18117	510109204	C
SCALE: 3:1	510109204	10/12/2009	SHEET	1 OF 2

4

3

2

1

