

4

3

2

1

DO NOT SCALE DRAWING

THE INFORMATION CONTAINED HEREIN IS THE EXCLUSIVE PROPERTY OF VIRGINIA PANEL CORPORATION AND IS SUBMITTED FOR USE BY THE CUSTOMER ONLY. THE DATA SHALL NOT BE DUPLICATED, USED, OR DISCLOSED IN WHOLE OR IN PART FOR ANY PURPOSE OTHER THAN TO MAINTAIN THE EQUIPMENT PROVIDED. CONSULT WITH VIRGINIA PANEL CORPORATION ENGINEERING IF MORE DETAIL IS REQUIRED.

REVISIONS			
REV	DESCRIPTION	DATE	ENGR
A	DRAWING ORIGATION - ECN #4565	4/12/13	R HERRON

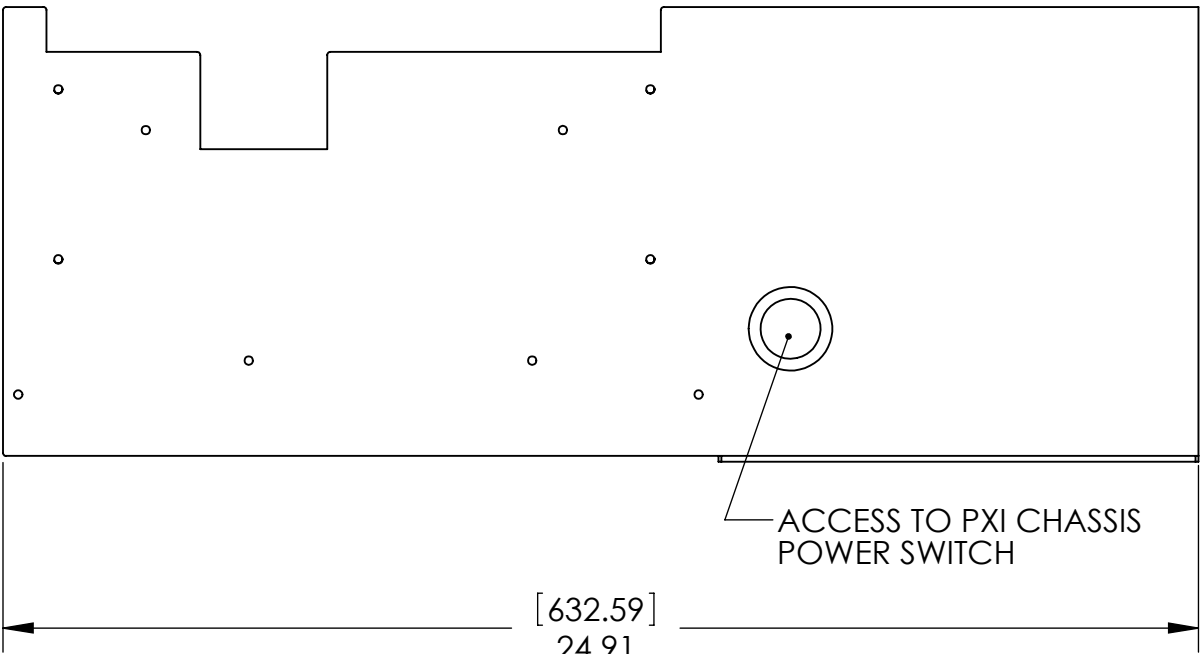

PXI-1042 LOCATION

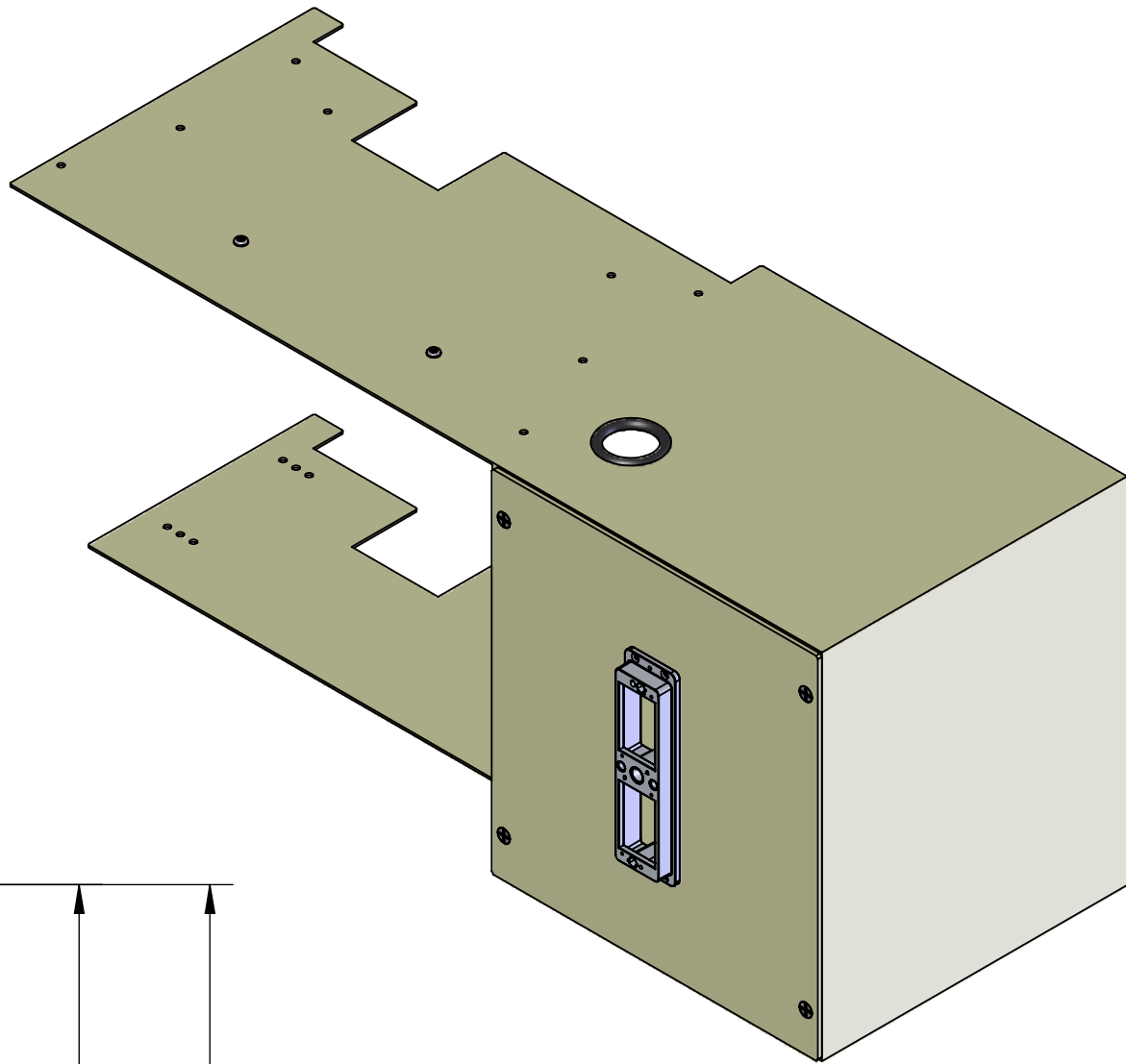
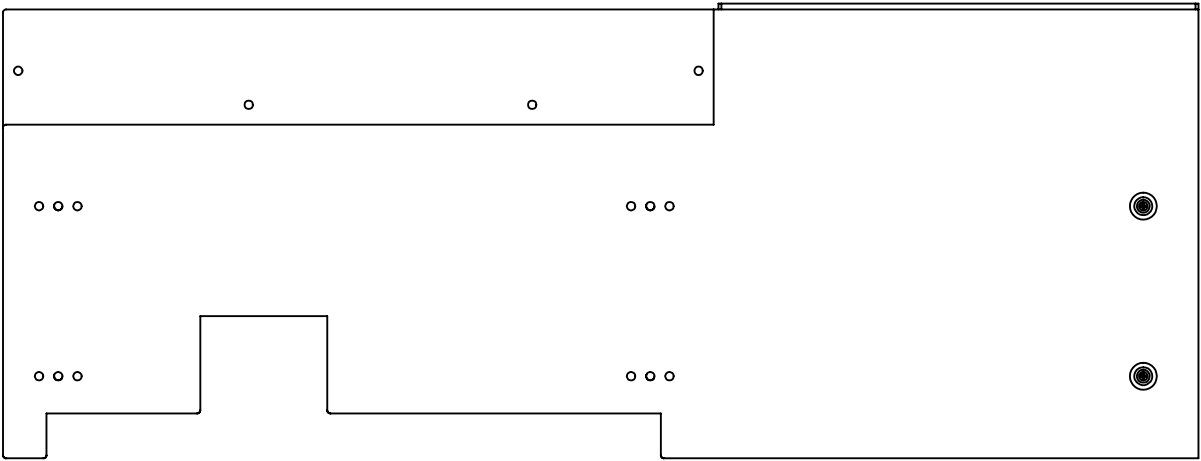
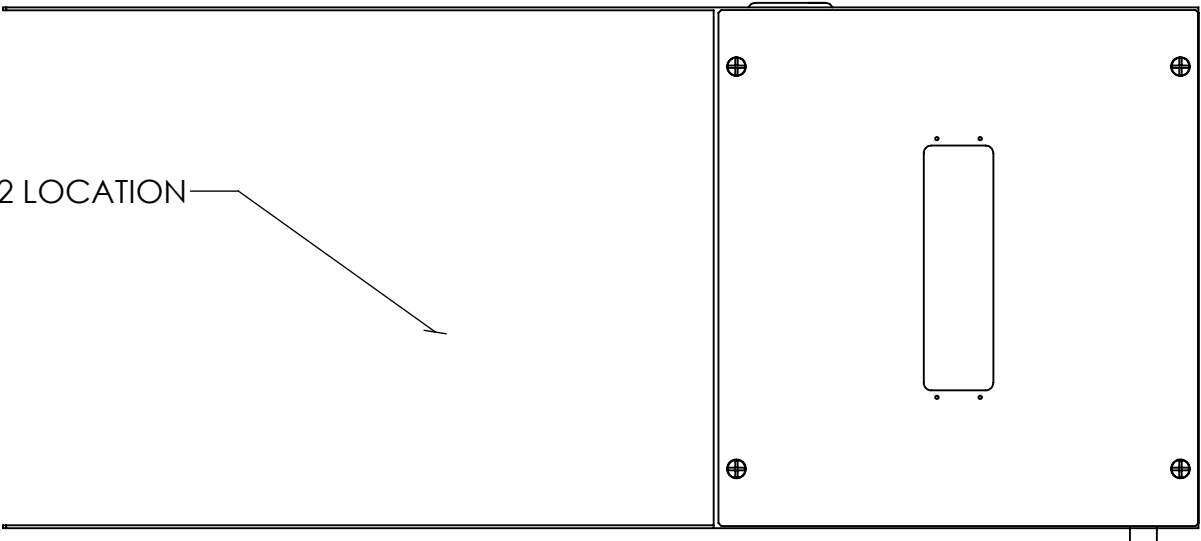

ICON RECEIVER (P/N 310104101)
SHOWN FOR REFERENCE ONLY.

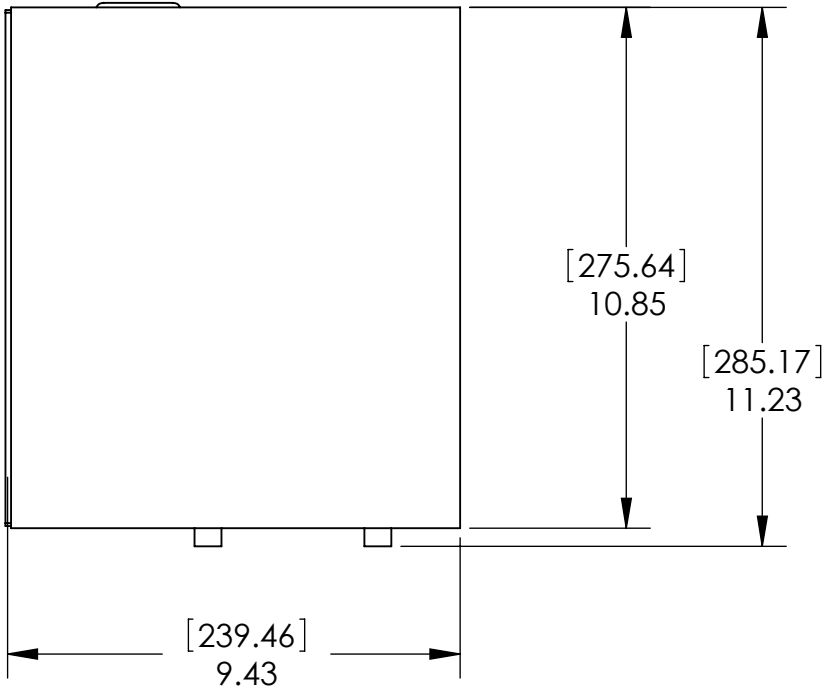

MOUNTING INSTRUCTIONS:

IT IS RECOMMENDED THAT ALL PXI CARDS ARE INSTALLED INTO THE PXI CHASSIS PRIOR TO INSTALLATION OF THE VPC ADAPTER.

REMOVE CARRY HANDLE AND FOUR RUBBER FEET FROM PXI CHASSIS. HANDLE WILL BE MOUNTED TO METAL PLATE PROVIDED WITH THE PMA-1115. SLIDE THE VPC ADAPTER (310113530) OVER THE PXI CHASSIS. THE POWER BUTTON OF THE PXI CHASSIS SHOULD BE ORIENTED TOWARDS THE TOP OF THE VPC ADAPTER. REPLACE THE RUBBER FEET WHICH NOW WILL ALSO GO THROUGH THE VPC ADAPTER. SECURE THE TOP OF THE VPC PART AND THE METAL PLATE PROVIDED WITH THE PMA-1115 (NOW WITH HANDLE ON IT) WITH PROVIDED M4 SCREWS. INSTALL THE PMA-1115 PER NATIONAL INSTRUMENTS INSTRUCTIONS. INSTALL THE REMAINING SCREWS ON THE TOP SIDE.

2. THIS PRODUCT WAS DESIGNED FOR USE WITH NATIONAL INSTRUMENTS PXI-1042 SERIES OF PXI CHASSIS AND NATIONAL INSTRUMENTS PMA-1115 MONITOR AND KEYBOARD.

1. FOR APPLICATION USE & CARE INFORMATION CONSULT VPC USERS GUIDE @WWW.VPC.COM

NOTES:

CUSTOMER DRAWING

VIRGINIA PANEL CORPORATION
WWW.VPC.COM

NI PXI 1042 TO ICON ADAPTER

DIMENSIONS ARE SHOWN AS:		SIZE	CAGE CODE	DWG. NO.	REV
[MILLIMETERS]		C	18117	310113530	A
INCHES		SCALE: 1:4	310113530	4/12/13	SHEET 1 OF 1