

4

3

2

1

DO NOT SCALE DRAWING

THE INFORMATION CONTAINED HEREIN IS THE EXCLUSIVE PROPERTY OF VIRGINIA PANEL CORPORATION AND IS SUBMITTED FOR USE BY THE CUSTOMER ONLY. THE DATA SHALL NOT BE DUPLICATED, USED, OR DISCLOSED IN WHOLE OR IN PART FOR ANY PURPOSE OTHER THAN TO MAINTAIN THE EQUIPMENT PROVIDED. CONSULT WITH VIRGINIA PANEL CORPORATION ENGINEERING IF MORE DETAIL IS REQUIRED.

REVISIONS

REV	DESCRIPTION	DATE	ENGR
A	DRAWING ORIGINATION - ECN #12641	6/15/22	R HERRON

D

D

C

C

B

B

A

A

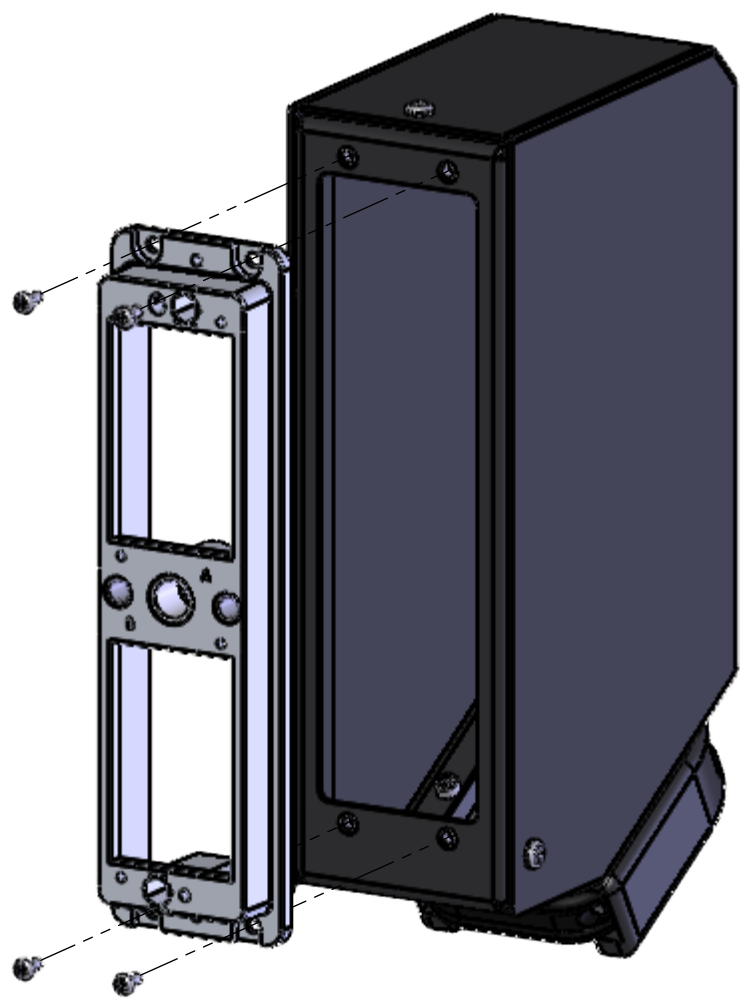
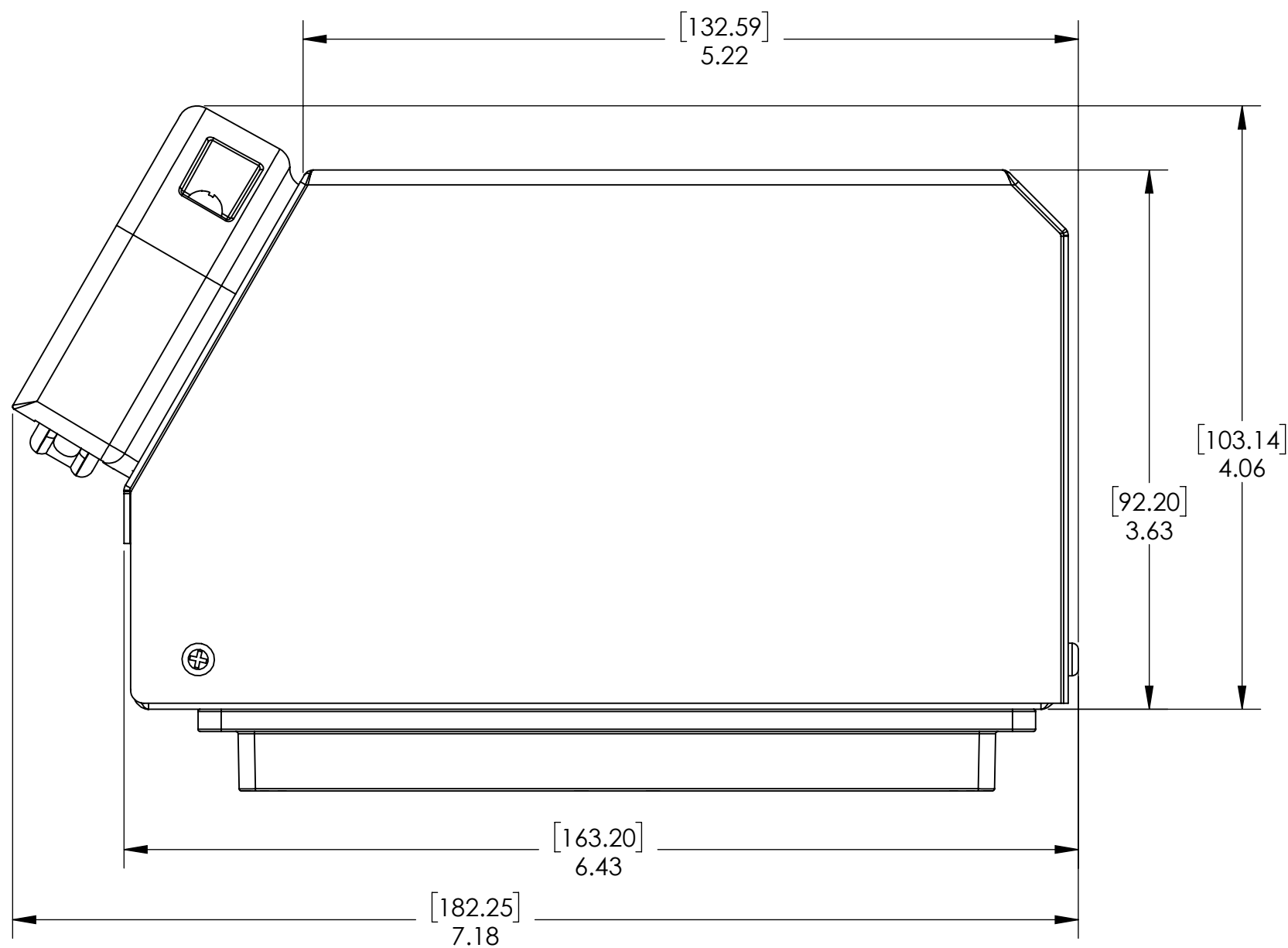
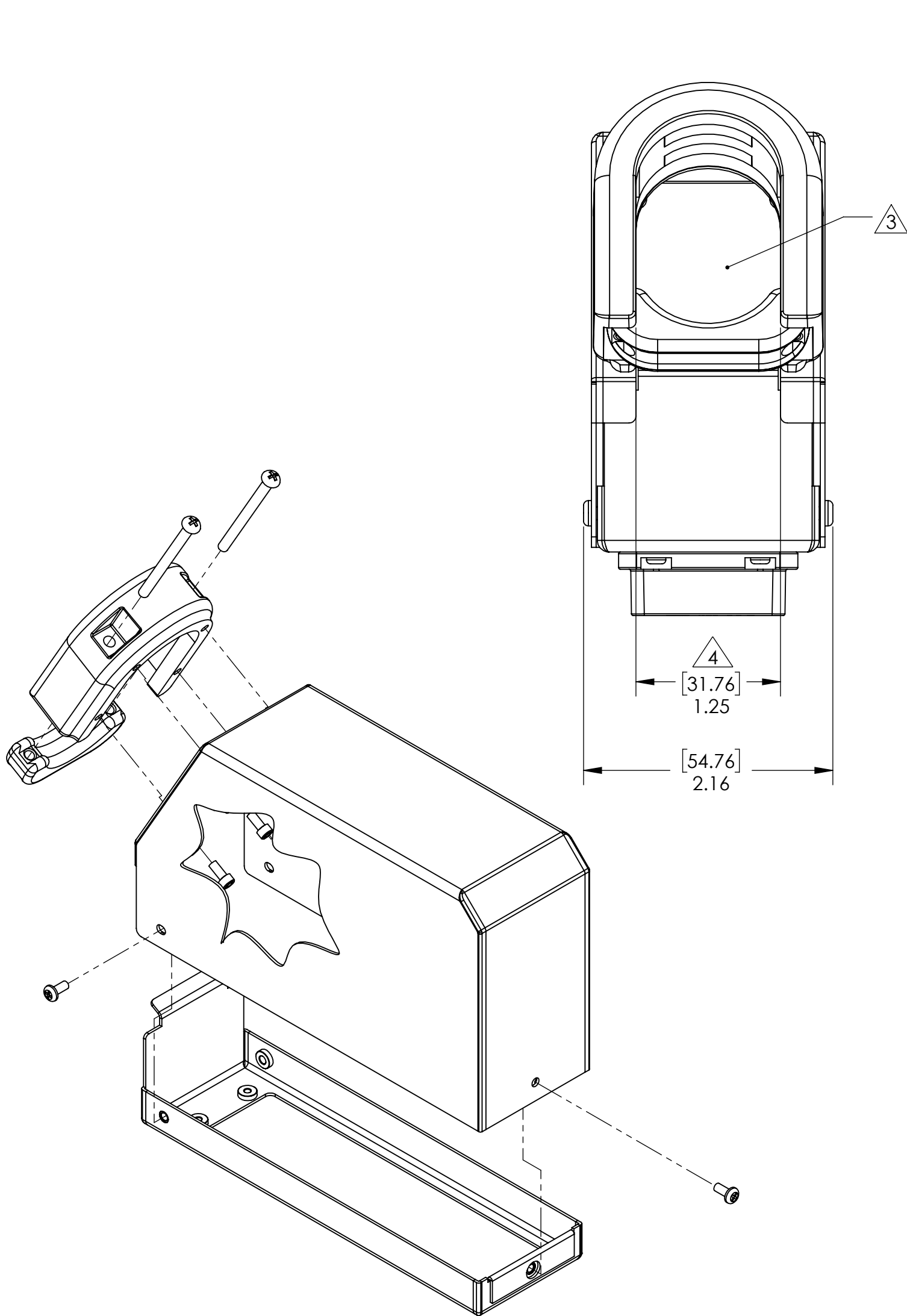

SHOWN WITH ICON RECEIVER (310123101)
RECEIVER SOLD SEPARATELY

4 OPENING ALLOWS THIS ENCLOSURE TO BE EASILY INSTALLED ON A PRE-WIRED RECEIVER

3 MAX CABLE BUNDLE AREA = 1.80 SQ. IN.

2. FOR USE WITH ALL ICON RECEIVERS.

1. MATERIALS:

BACKSHELL BODY: ALUMINUM ALLOY, POWDER COATED BLACK

CABLE CLAMP ASSEMBLY: BLACK NYLON BUSHING WITH CHROMATE AND POWDER COATED MATTE BLACK ALUMINUM CLAMP

HARWARE: STAINLESS STEEL

NOTES:

RELATIVE CONNECTOR POSITIONS
AND WIRE ROUTING ARE GENERIC
AND MAY VARY WITH PINOUT

DIMENSIONS ARE SHOWN AS:
[MILLIMETERS]
INCHES

CUSTOMER DRAWING				
VIRGINIA PANEL CORPORATION				
WWW.VPC.COM				
BACKSHELL, ICON, RCV				
SIZE	CAGE CODE	DWG.NO.	REV	
C	18117	310113794	A	
SCALE: 1:2		310113794	SHEET 1 OF 1	

4

3

2

1