

4

3

2

1

DO NOT SCALE DRAWING

THE INFORMATION CONTAINED HEREIN IS THE EXCLUSIVE PROPERTY OF VIRGINIA PANEL CORPORATION AND IS SUBMITTED FOR USE BY THE CUSTOMER ONLY. THE DATA SHALL NOT BE DUPLICATED, USED, OR DISCLOSED IN WHOLE OR IN PART FOR ANY PURPOSE OTHER THAN TO MAINTAIN THE EQUIPMENT PROVIDED. CONSULT WITH VIRGINIA PANEL CORPORATION ENGINEERING IF MORE DETAIL IS REQUIRED.

REVISIONS

REV	DESCRIPTION	DATE	ENGR
J	ECN #13008	11/10/22	R HERRON

D

D

C

C

B

B

A

A

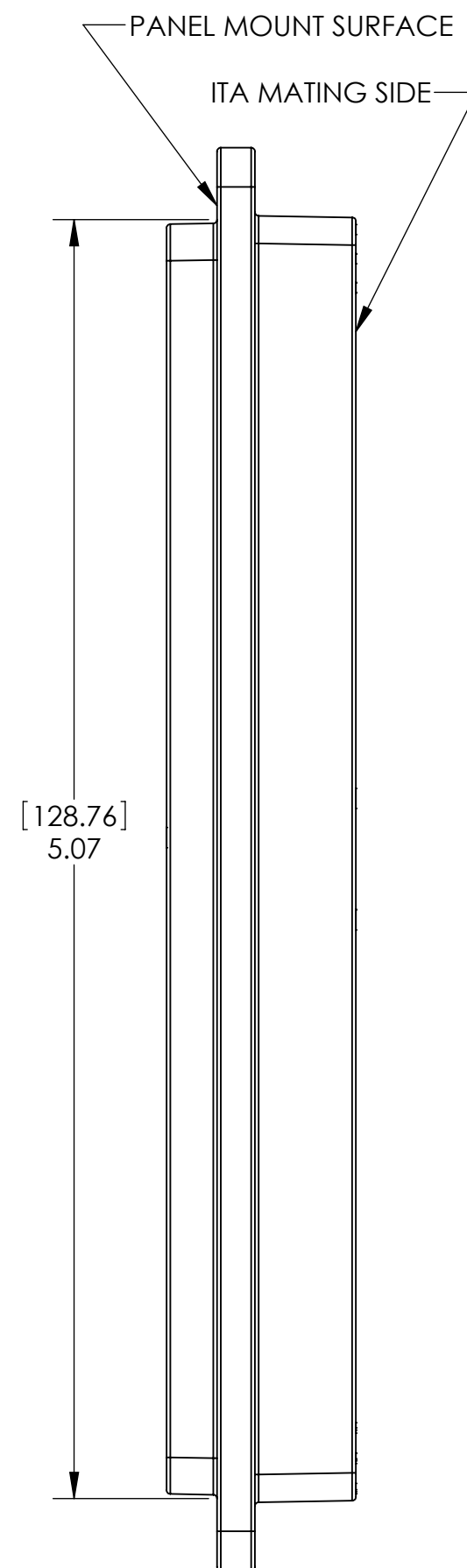

[2.87]  
4X Ø.113 THRU

PANEL MOUNT HOLE,  
HARDWARE SUPPLIED.  
LOCATION FOR SECURING  
PROTECTIVE COVER, 4X

MODULE TIER "A"

MODULE TIER "B"

HEX CAVITY 2X FOR  
OPTIONAL KEYING PINS  
(KIT P/N 310113461)

[22.86]  
.90 TYP.

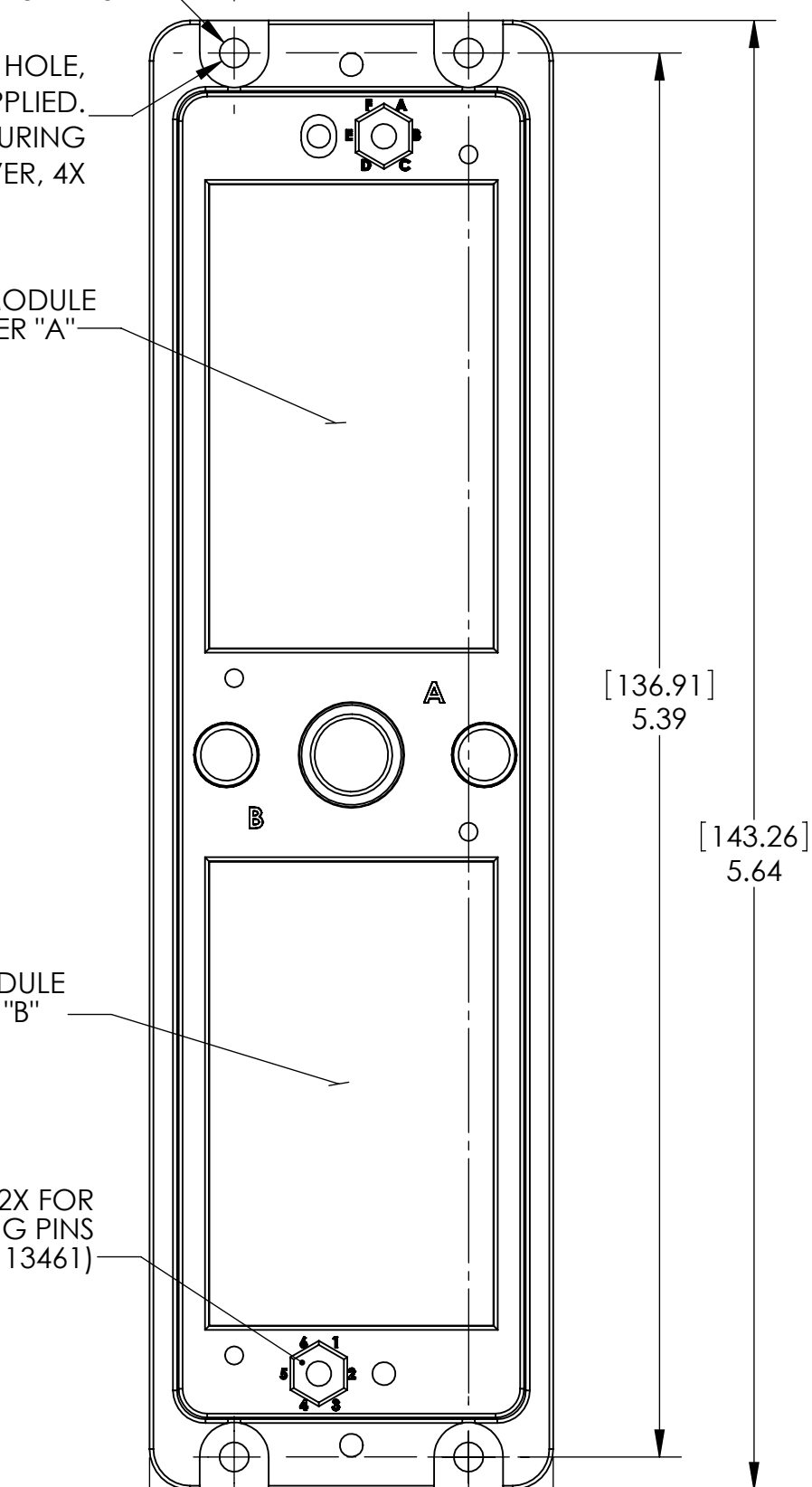

ITA MATING VIEW

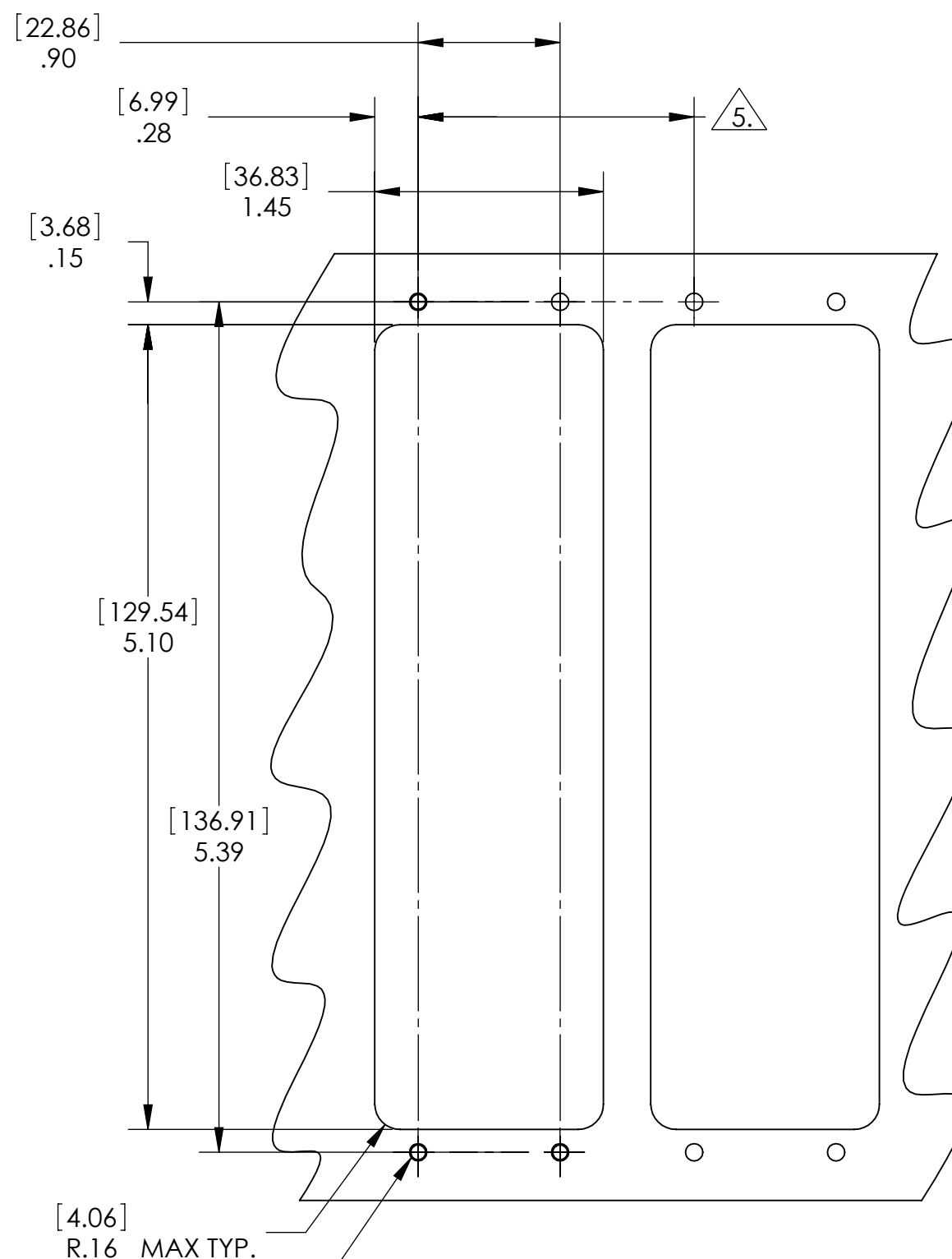
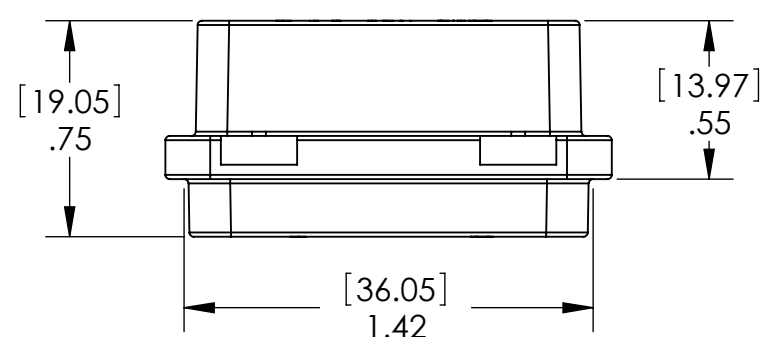

FOR MOUNTING USE  
Ø [2.79].11 THRU HOLE,  
2-56 OR M2.5 METRIC  
TAPPED HOLE  
(SUPPLIED WITH 4X, 2-56 SCREWS,  
LOCK WASHERS & NUTS)

**RECOMMENDED PANEL CUTOUT**

TOLERANCES ARE:  
.XX = ±.01 [.25]  
.XXX = ±.005 [.13]  
UNLESS OTHERWISE SPECIFIED

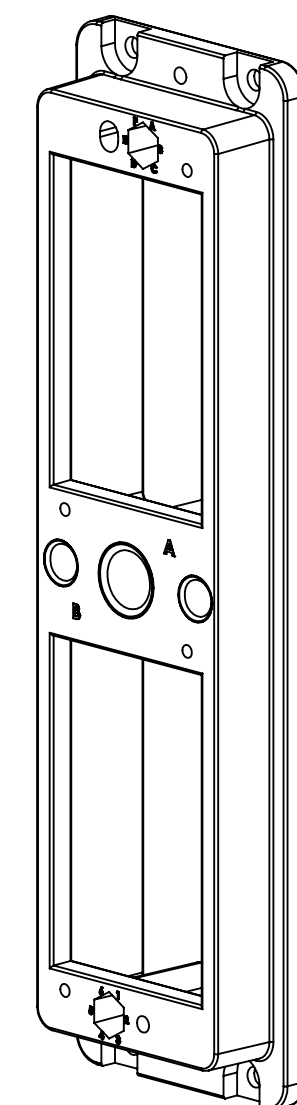

5 SEE TABLE 1 IN SECTION 3-1 OF THE USER'S MANUAL FOR MINIMUM DISTANCE OF SUBSEQUENT SIDE BY SIDE CUTOUTS.

4. PROTECTIVE COVER INCLUDED WITH ASSEMBLY (NOT SHOWN)

3. MOUNTING HARDWARE SHIPPED LOOSE IN BAG

2. MATERIALS:  
FRAME: ALUMINUM ALLOY - Ni PLATED  
HARDWARE - STAINLESS STEEL ALLOY  
PROTECTIVE COVER - BLACK THERMOPLASTIC

<b>CUSTOMER DRAWING</b>			
<b>VPC</b>			
WWW.VPC.COM			
<b>ICON RECEIVER</b>			
DIMENSIONS ARE SHOWN AS:	SIZE	CAGE CODE	DWG. NO.
[MILLIMETERS]	C	18117	310123101
INCHES			
SCALE: 1:1	310123101	8/24/06	SHEET 1 OF 1

4

3

2

1