

4

3

2

1

DO NOT SCALE DRAWING

THE INFORMATION CONTAINED HEREIN IS THE EXCLUSIVE PROPERTY OF VPC AND IS PERMITTED FOR USE BY THE CUSTOMER ONLY. THE DATA SHALL NOT BE DUPLICATED, USED, OR DISCLOSED IN WHOLE OR IN PART FOR ANY PURPOSE OTHER THAN TO MAINTAIN THE EQUIPMENT PROVIDED. CONSULT WITH VPC ENGINEERING IF MORE DETAIL IS REQUIRED.

REV	DESCRIPTION	DATE	ENGINEER
F	ECN #14238	5/31/24	M SALE

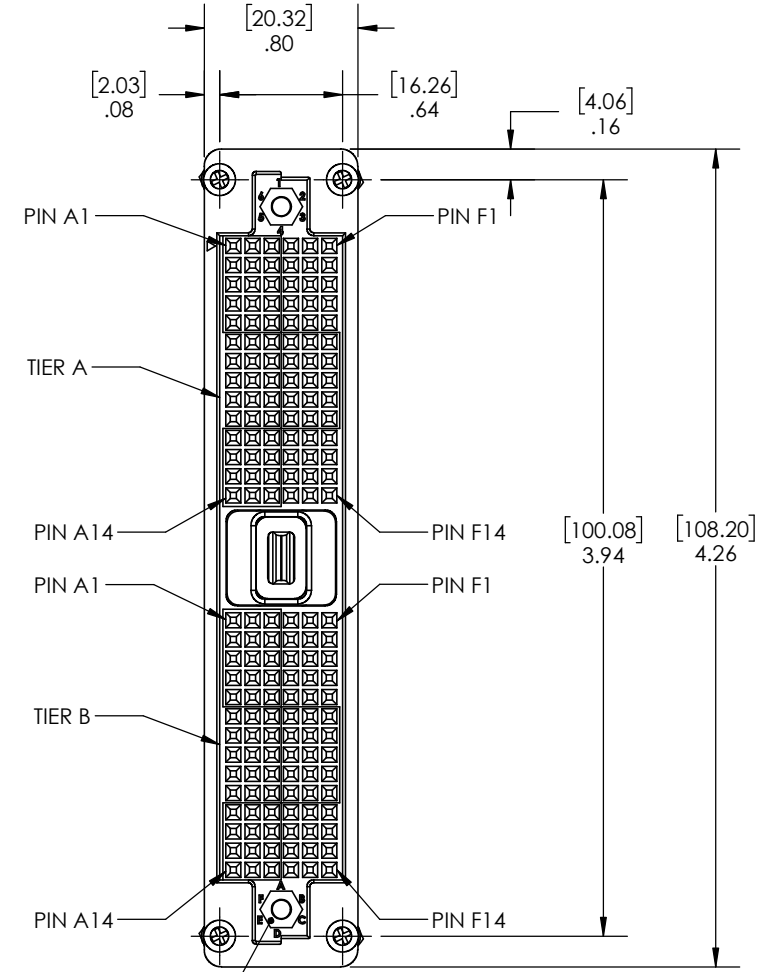
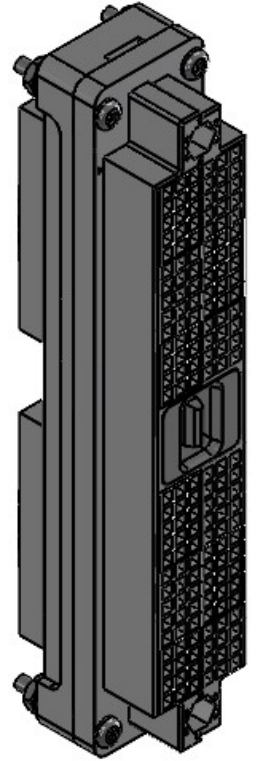

CAVITY FOR KEYING KIT, TYP. 2 PLCS.  
ACCESSORY P/N 310113461 (2 KEYS PER KIT)  
NOT INCLUDED WITH RECEIVER

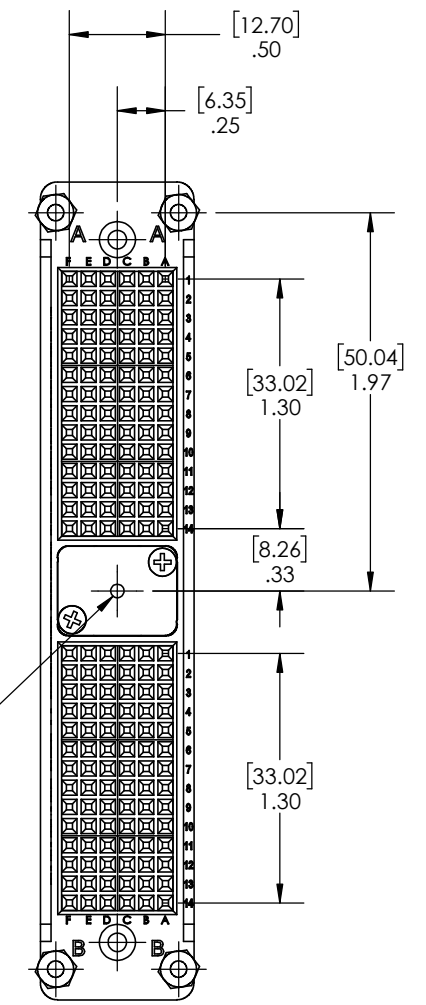
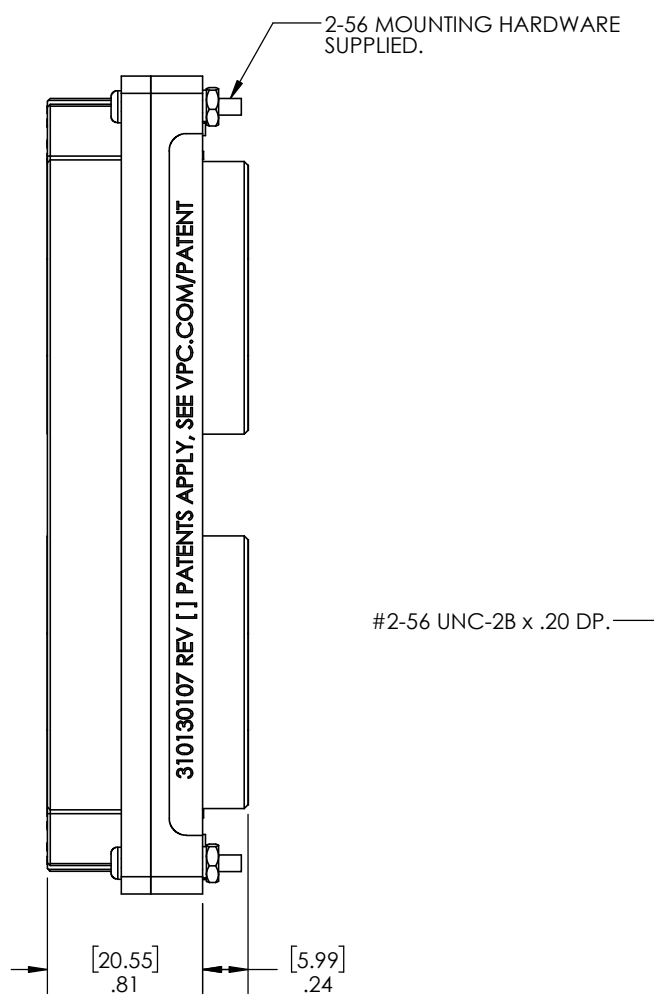
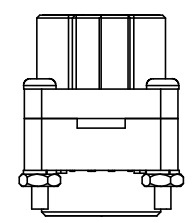

- 3. RECEIVER COMPATIBLE WITH TWIN FEMALE QUADRAPADDLE CONTACTS, VPC P/N 610138200.
  - 2. MATERIALS:  
HOUSING: BLACK THERMOPLASTIC  
BUSHING: STAINLESS STEEL  
LATCH POST: STAINLESS STEEL  
MOUNTING HARDWARE: STAINLESS STEEL
  - 1. FOR MORE INFORMATION, VISIT VPC.COM.
- NOTES:

CUSTOMER DRAWING



i2 RCV ASM, 168 PIN W/O CNTS

DIMENSIONS ARE SHOWN AS:  
[MILLIMETERS]  
INCHES

DWG.NO.	REV
310130107	F
SCALE	CAGE CODE
NONE	18117
SHEET	1 OF 2

4

3

2

1

1.75 RECOMMENDED UNIVERSAL SPACING  
 1.00 NARROW SPACING (NON XL ITA)  
 (SEE TABLE 1 BELOW)

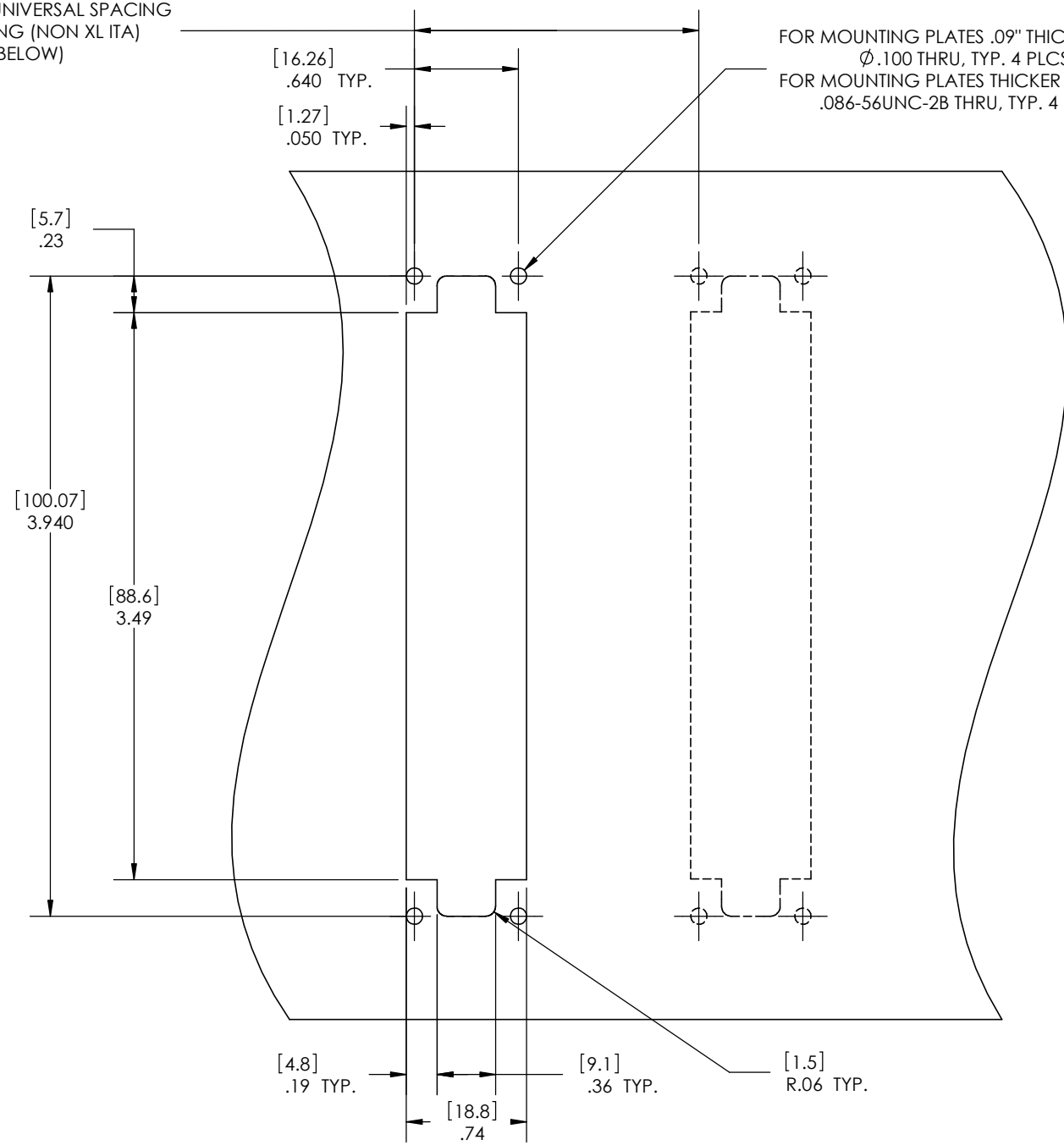

TOLERANCES ARE:  
 .XX =  $\pm$ [.25].01  
 .XXX =  $\pm$ [.13].005  
 UNLESS OTHERWISE SPECIFIED

### PANEL MOUNTING DETAIL

TABLE 1			
MATING ITA PART NUMBER	DESCRIPTION	RECOMMENDED RECEIVER CUTOUT SPACING	MINIMUM RECEIVER CUTOUT SPACING
410130101	ITA, i2 Micro iCon, 168 Position	1.75 [44.45]	1.00 [25.40]
410130106	ITA, i2 Micro iCon, 168 Position with Oversized Backshell	1.75 [44.45]	1.75 [44.45]
410130124	ITA, i2 Micro iCon, 168 Position	1.75 [44.45]	1.00 [25.4]

### CUSTOMER DRAWING - CUSTOMER DRAWING - CUSTOMER DRAWING

THE INFORMATION CONTAINED HEREIN IS THE EXCLUSIVE PROPERTY OF VPC AND IS PERMITTED FOR USE BY THE CUSTOMER ONLY. THE DATA SHALL NOT BE DUPLICATED, USED, OR DISCLOSED IN WHOLE OR IN PART FOR ANY PURPOSE OTHER THAN TO MAINTAIN THE EQUIPMENT PROVIDED.

DWG.NO.		310130107		REV	F
SIZE	SCALE	CAGE CODE	SHEET		
B	NONE	18117	2 OF 2		

DO NOT SCALE DRAWING