

4

3

2

1

DO NOT SCALE DRAWING

THE INFORMATION CONTAINED HEREIN IS THE EXCLUSIVE PROPERTY OF VIRGINIA PANEL CORPORATION AND IS SUBMITTED FOR USE BY THE CUSTOMER ONLY. THE DATA SHALL NOT BE DUPLICATED, USED, OR DISCLOSED IN WHOLE OR IN PART FOR ANY PURPOSE OTHER THAN TO MAINTAIN THE EQUIPMENT PROVIDED. CONSULT WITH VIRGINIA PANEL CORPORATION ENGINEERING IF MORE DETAIL IS REQUIRED.

REVISIONS

REV	DESCRIPTION	DATE	ENGR
C	ECN #14975	5/9/25	RF

D

D

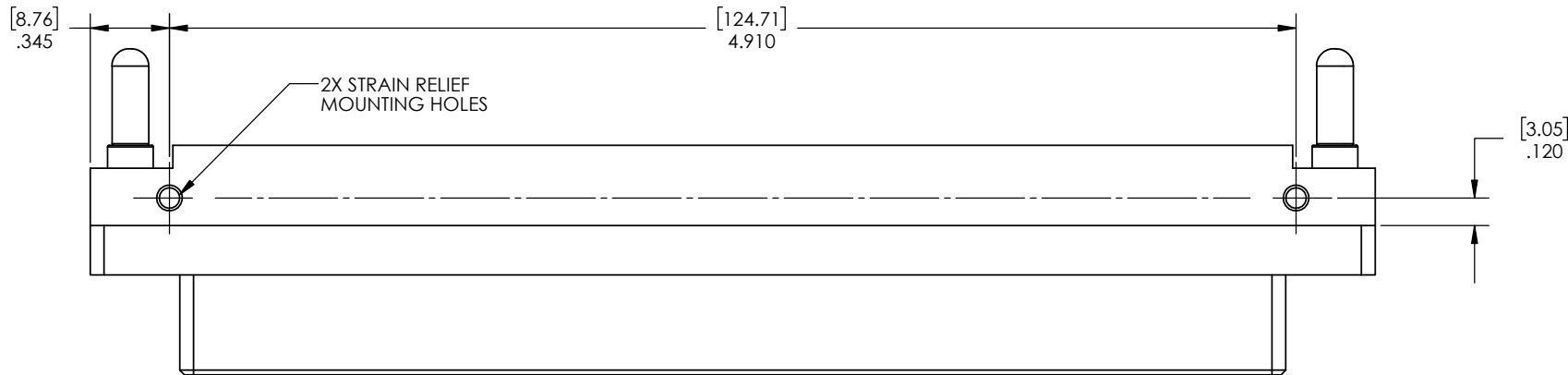

C

C

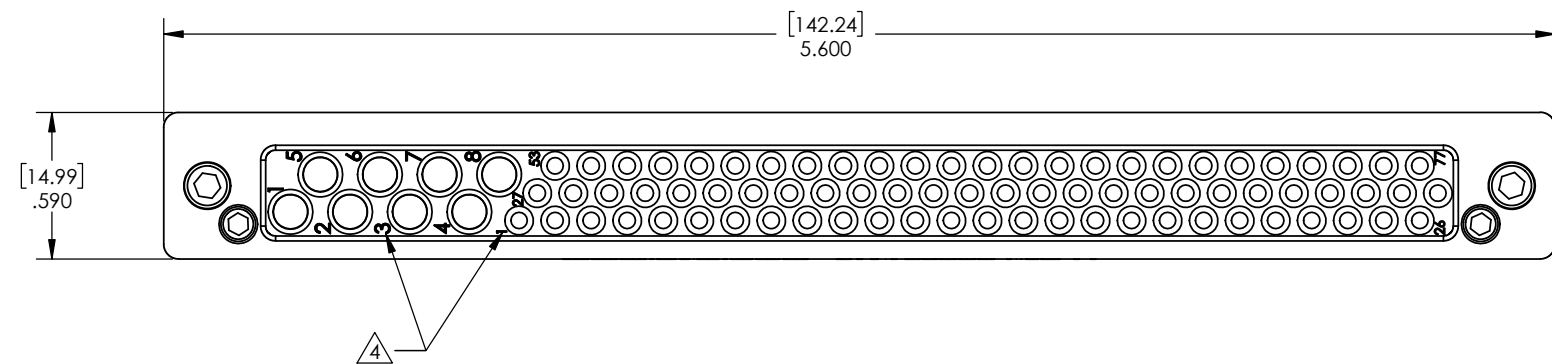

B

B

A

A

4 CONNECTOR POSITIONS MARKED AS SHOWN

3. MATING ITA MODULE: 510108278
STRAIN RELIEF PLATE: 510109116

2. MATERIALS:
MODULE - PAINTED G10/FR4 GLASS EPOXY LAMINATE
HARDWARE - STAINLESS STEEL
LOCATOR - THERMOPLASTIC

1. FOR APPLICATION USE & CARE INFORMATION CONSULT VPC USERS GUIDE @WWW.VPC.COM
NOTES:

CUSTOMER DRAWING

VIRGINIA PANEL CORPORATION
WWW.VPC.COM

RCV MODULE, 90 SERIES
HYBRID 77/8 TRIPADDLE/MICRO

DIMENSIONS ARE SHOWN AS:
[MILLIMETERS]
INCHES

SIZE	CAGE CODE	DWG. NO.	REV
C	18117	510104306	C
SCALE: 2:1		510104306	8/29/12
		SHEET	1 OF 1

4

3

2

1