

4

3

2

1

DO NOT SCALE DRAWING

THE INFORMATION CONTAINED HEREIN IS THE EXCLUSIVE PROPERTY OF VIRGINIA PANEL CORPORATION AND IS SUBMITTED FOR USE BY THE CUSTOMER ONLY. THE DATA SHALL NOT BE DUPLICATED, USED, OR DISCLOSED IN WHOLE OR IN PART FOR ANY PURPOSE OTHER THAN TO MAINTAIN THE EQUIPMENT PROVIDED. CONSULT WITH VIRGINIA PANEL CORPORATION ENGINEERING IF MORE DETAIL IS REQUIRED.

REVISIONS

REV	DESCRIPTION	DATE	ENGR
E	ECN #14975	5/9/25	RF

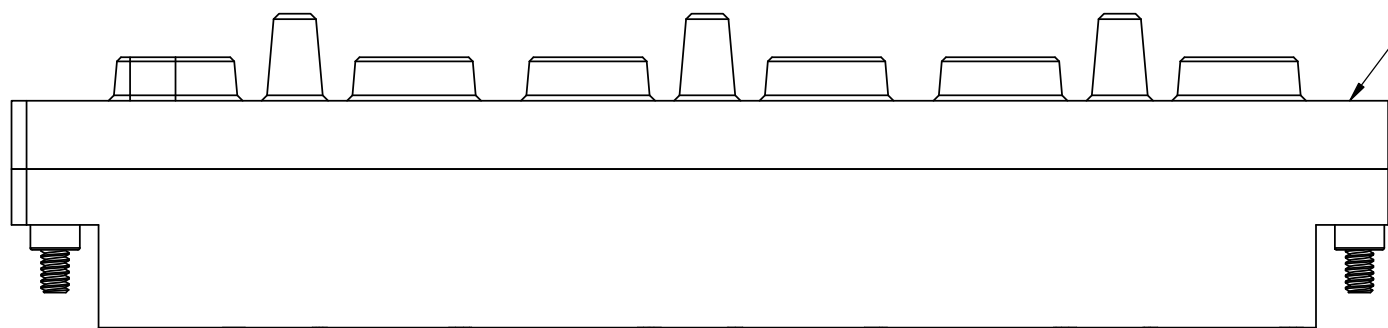
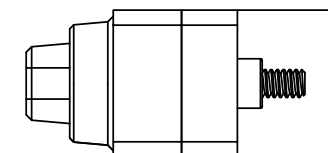
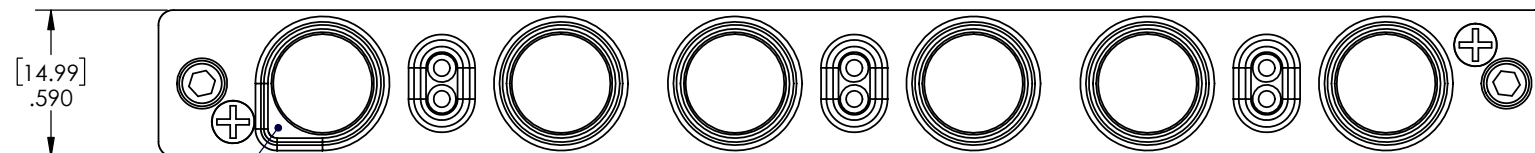
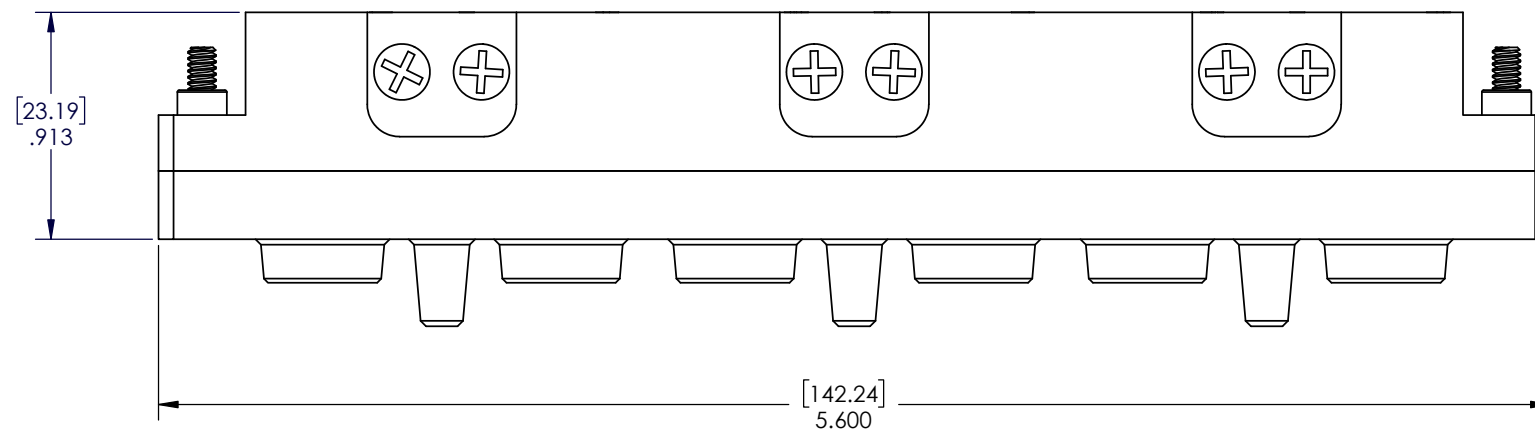
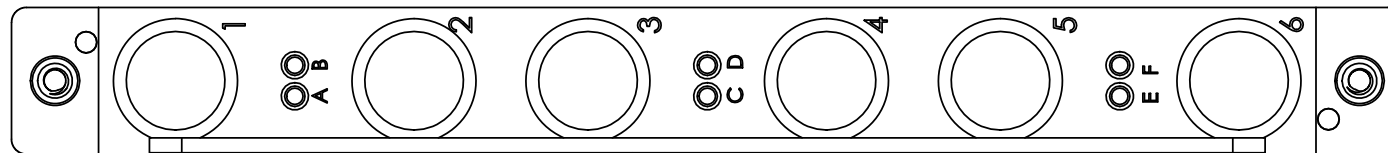

3. STRAIN RELIEF PLATE NOT SHOWN

2. MATERIALS:
HOUSING - FR4/G10, PAINTED
HARDWARE - STAINLESS STEEL
LOCATOR - THERMOPLASTIC

1. FOR APPLICATION USE & CARE INFORMATION CONSULT VPC USERS GUIDE @WWW.VPC.COM
NOTES:

DIMENSIONS ARE SHOWN AS:
[MILLIMETERS]
INCHES

CUSTOMER DRAWING			
VIRGINIA PANEL CORPORATION WWW.VPC.COM			
RCV MODULE, 90S 150 AMP POWER			
SIZE	CAGE CODE	DWG. NO.	REV
C	18117	510104307	E
SCALE: 2:1	510104307	7/3/13	SHEET 1 OF 1

4

3

2

1