

DO NOT SCALE DRAWING

THE INFORMATION CONTAINED HEREIN IS THE EXCLUSIVE PROPERTY OF VIRGINIA PANEL CORPORATION AND IS SUBMITTED FOR USE BY THE CUSTOMER ONLY. THE DATA SHALL NOT BE DUPLICATED, USED OR DISCLOSED IN WHOLE OR IN PART FOR ANY PURPOSE OTHER THAN TO MAINTAIN THE EQUIPMENT PROVIDED. CONSULT WITH VIRGINIA PANEL CORPORATION ENGINEERING IF MORE DETAIL IS REQUIRED.

REVISIONS			
REV	DESCRIPTION	DATE	ENGR
G	ECN# 12391	5/10/22	R HERRON

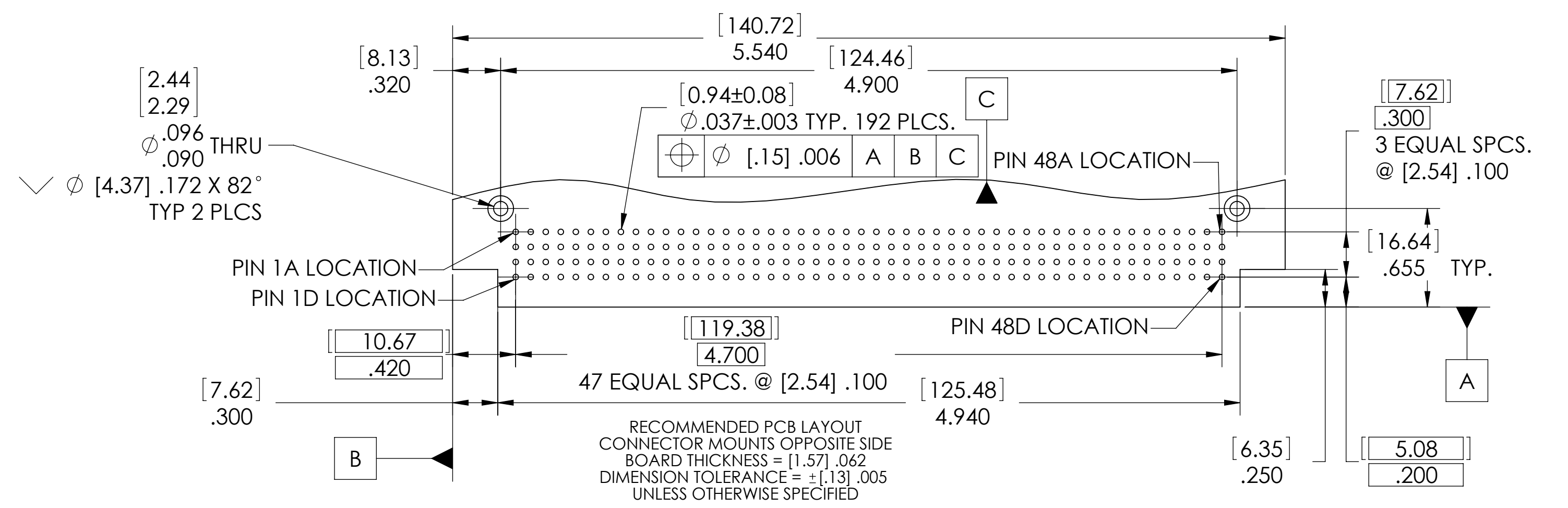
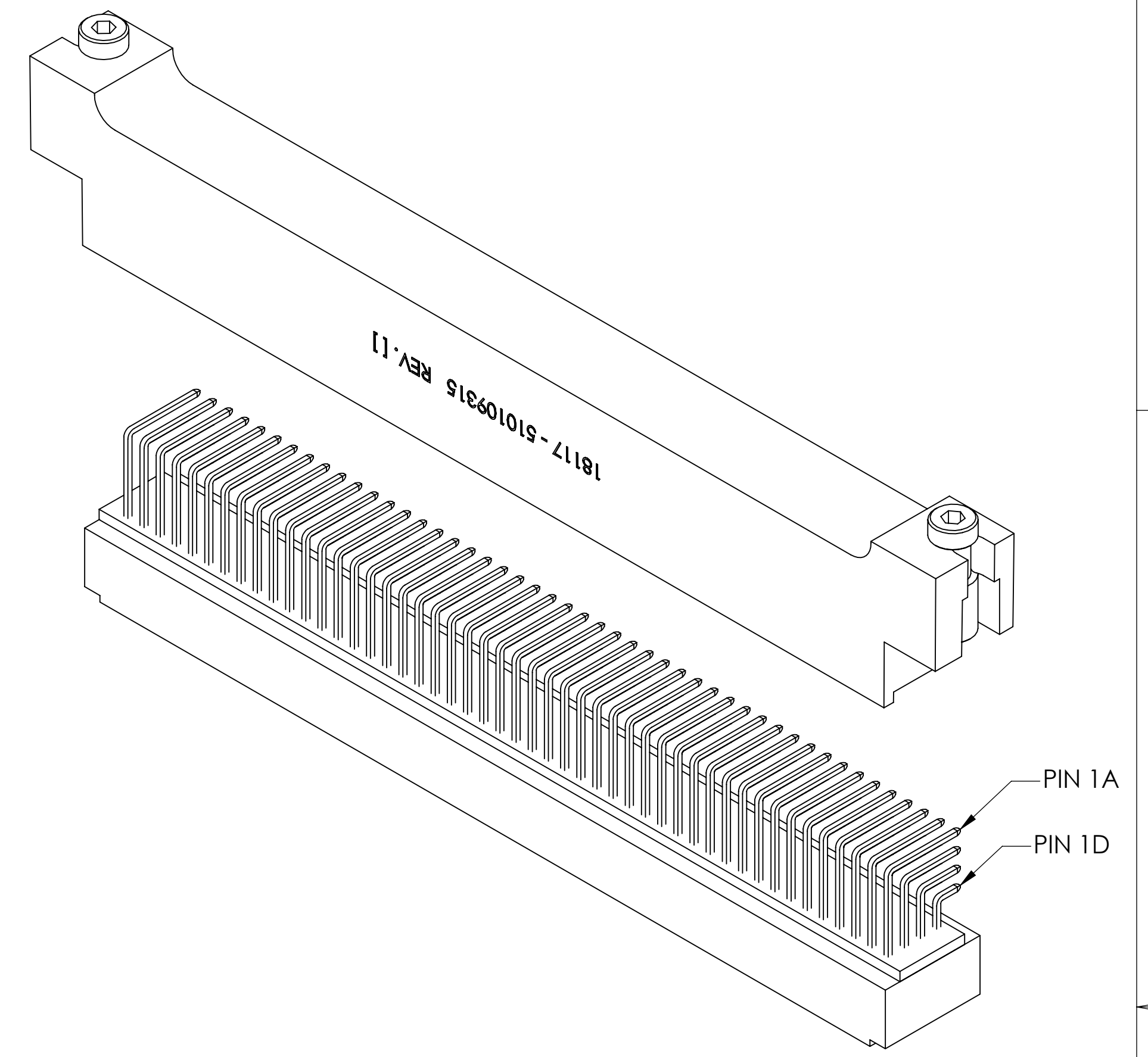
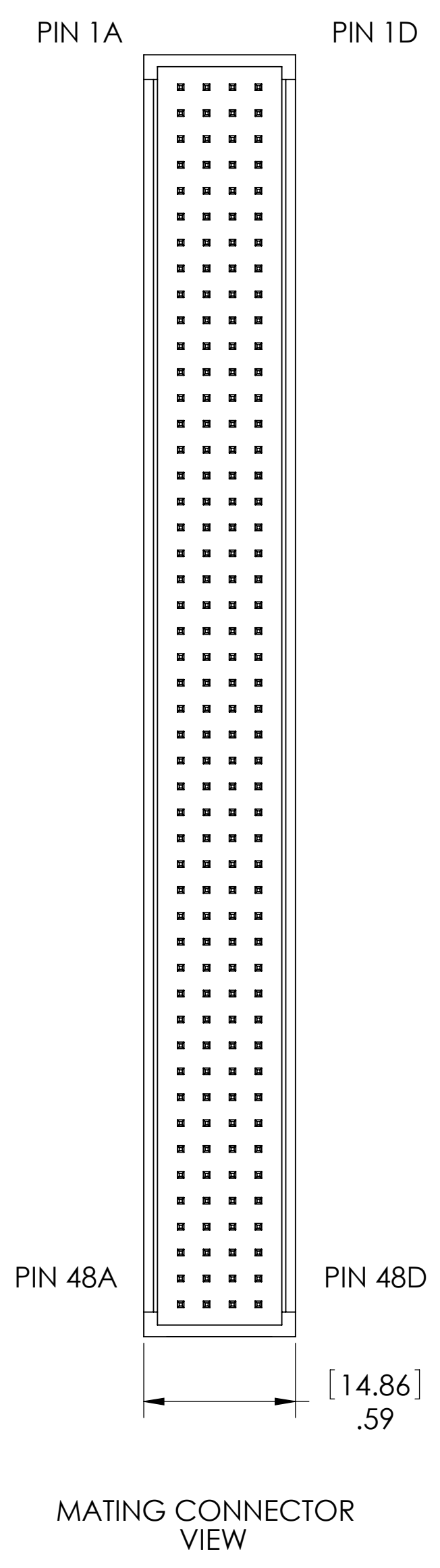
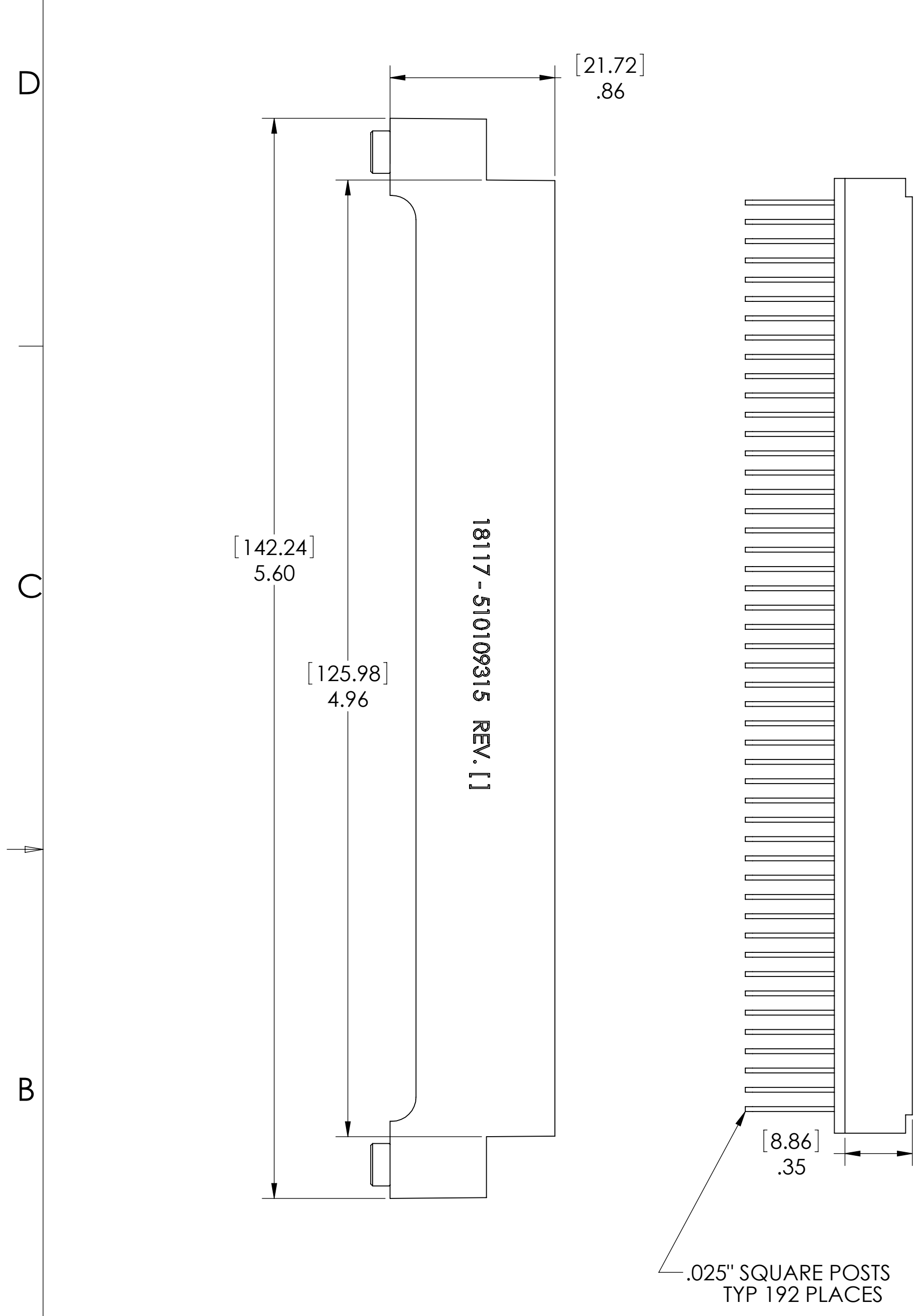

- 6 USE WITH RECEIVER MODULE 510 150 130
- 5 ALL NECESSARY HARDWARE FOR ASSEMBLY SUPPLIED IN KIT
- 4 CUSTOMER PCB MUST BE MANUFACTURED WITH (HEADER) INSTALLATION AREA COMPLYING TO RECOMMENDED PCB LAYOUT

- 3 MATERIALS:
 HARDWARE: STAINLESS STEEL SCREWS
 BRASS ALLOY STANDOFFS NI PLATED
 SHROUD: ABS PLASTIC OR EQUIVALENT
 HEADER - INSULATOR: GLASS FILLED PET BLACK THERMOPLASTIC
 CONTACT: PHOSPHOR BRONZE ALLOY
 CONTACT PLATING IN MATING AREA: .00003 in. Au OVER .00005 in. Ni

- 2 FOR DETAILED ASSEMBLY INSTRUCTIONS REFER TO SECTION ABOVE
- 1 FOR APPLICATION USE AND CARE INFORMATION CONSULT VPC USERS GUIDE @ WWW.VPC.COM

NOTES:

CUSTOMER DRAWING			
VIRGINIA PANEL CORPORATION			
WWW.VPC.COM			
RIGHT ANGLE MALE HEADER/SHROUD KIT FOR 192 POSITION QP RECEIVER MODULE			
DIMENSIONS ARE SHOWN AS:	SIZE	CAGE CODE	DWG NO.
[MILLIMETERS]	D	18117	510109315
INCHES	SCALE: NONE	510109315	6/13/03 SHEET 1 OF 1

DO NOT SCALE DRAWING

THE INFORMATION CONTAINED HEREIN IS THE EXCLUSIVE PROPERTY OF VIRGINIA PANEL CORPORATION AND IS SUBMITTED FOR USE BY THE CUSTOMER ONLY. THE DATA SHALL NOT BE DUPLICATED, USED OR DISCLOSED IN WHOLE OR IN PART FOR ANY PURPOSE OTHER THAN TO MAINTAIN THE EQUIPMENT PROVIDED. CONSULT WITH VIRGINIA PANEL CORPORATION ENGINEERING IF MORE DETAIL IS REQUIRED.

REVISIONS			
REV	DESCRIPTION	DATE	ENGR
G	ECN #12391	5/10/22	R HERRON

ASSEMBLY INSTRUCTIONS

1. ASSEMBLE - SOLDER (HEADER - ITEM #3) TO YOUR PCB (RECOMMENDED IPC-A-610 STANDARD) (SEE FIG. 1)
2. FASTEN THE (SHROUD ASM - ITEMS #1 & #2) TO YOUR PCB USING THE 2 (2-56 x .25 FH PHL SCREWS - ITEM #5) (SEE FIG. 2)
3. USING A 3/32" HEX WRENCH REPLACE THE TWO 4-40 RECEIVER MODULE MOUNTING SCREWS WITH THE 2 (4-40 x 1-1/4" SCREWS - ITEM #4) (SEE FIG. 3)
4. ACCESSING THE BACKSIDE OF VPC'S RECEIVER, INSTALL (STAND OFFS - ITEMS #6 & #7) ACCORDING TO TABLE 1 BELOW (SEE FIG. 4)
5. USING A 3/32" HEX WRENCH CAREFULLY INSTALL THE PCB ASSEMBLY ONTO THE BACKSIDE OF VPC'S RECEIVER MODULE INSURING THAT PIN 1A OF THE MODULE AND PIN 1A OF THE PCB ASSEMBLY COINCIDE. FOR BEST RESULTS ONLY TURN SCREWS 1-1/2 TO 2 TURNS EACH ALTERNATELY UNTIL ASSEMBLY IS COMPLETE. ***DO NOT OVERTIGHTEN*** (SEE FIG. 5)
6. TO UNMATE THE PCB ASSEMBLY FROM THE ITA MODULE USE THE SAME ALTERNATING PATTERN OF 1-1/2 TO 2 TURNS UNTIL PCB ASSEMBLY IS FULLY DISENGAGED

FIG 1

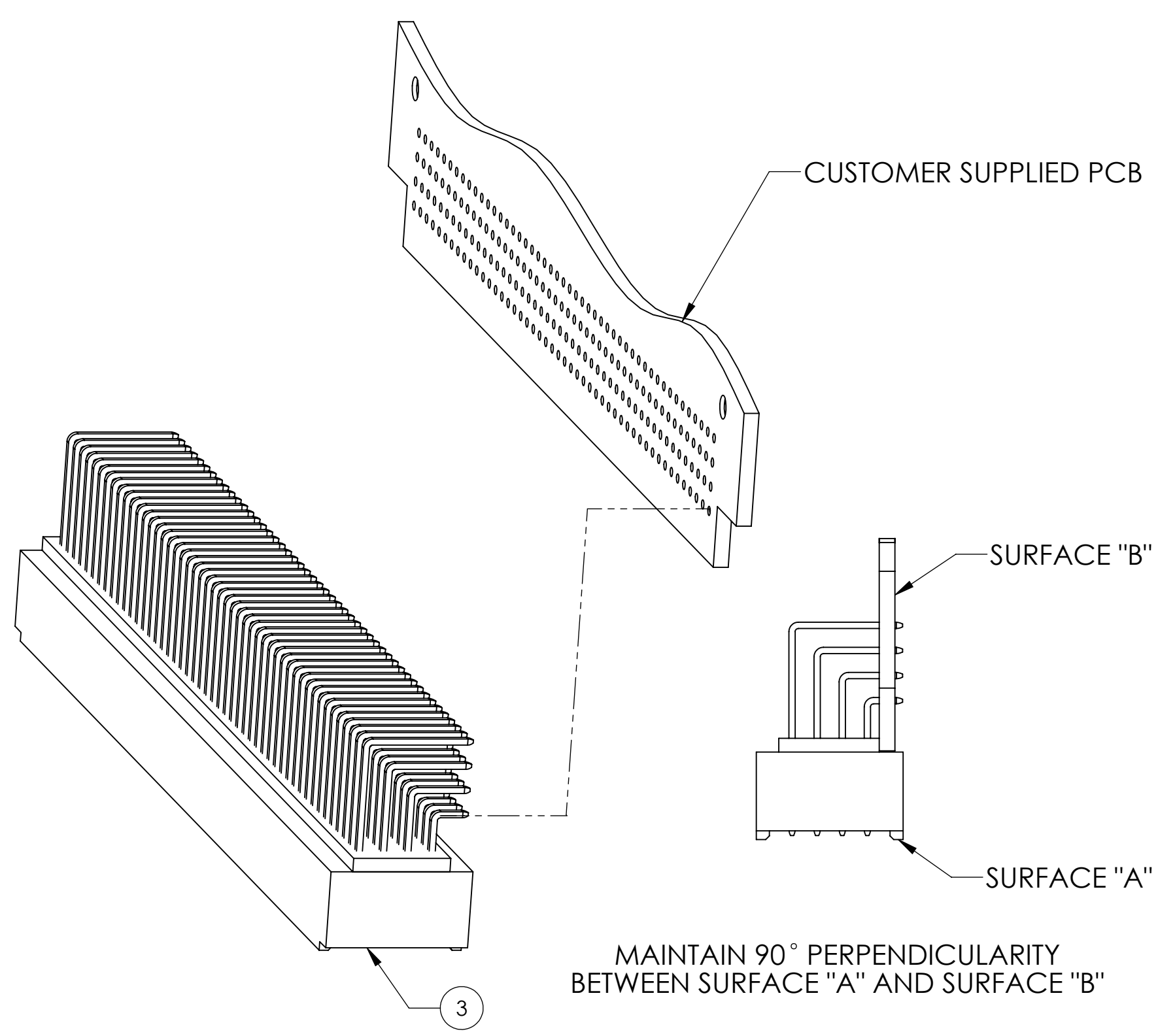

FIG 2

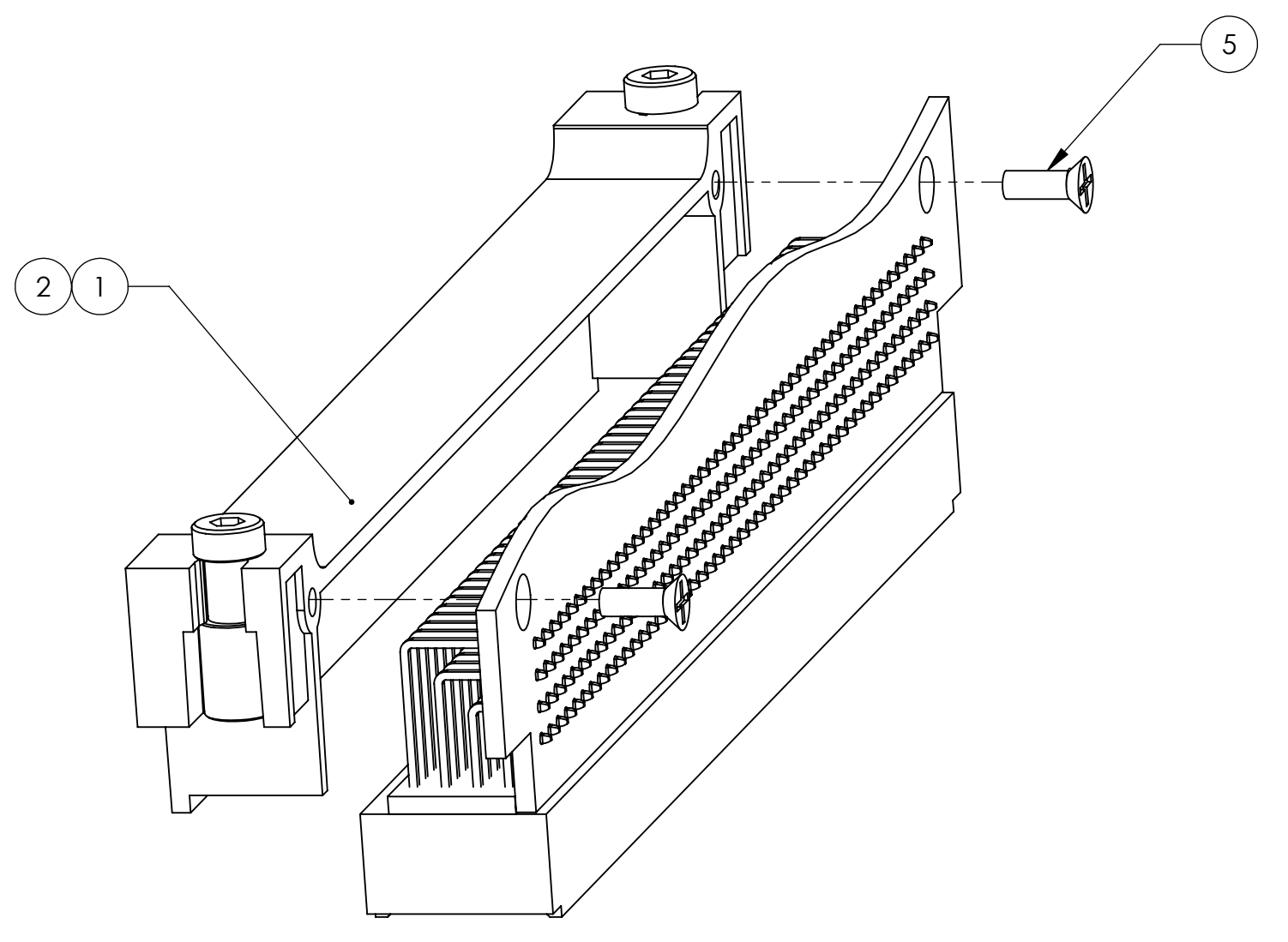

FIG 3

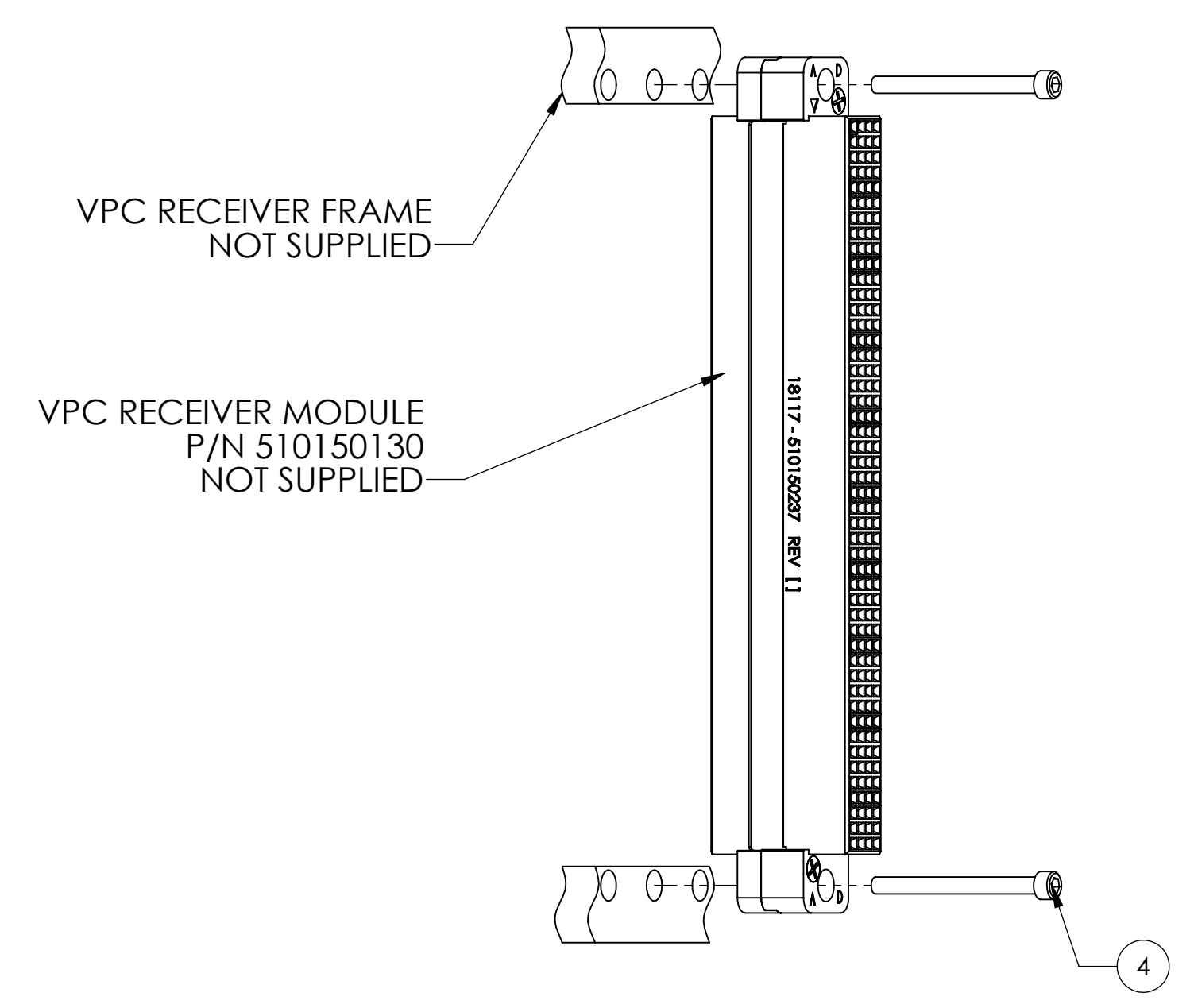

FIG 4

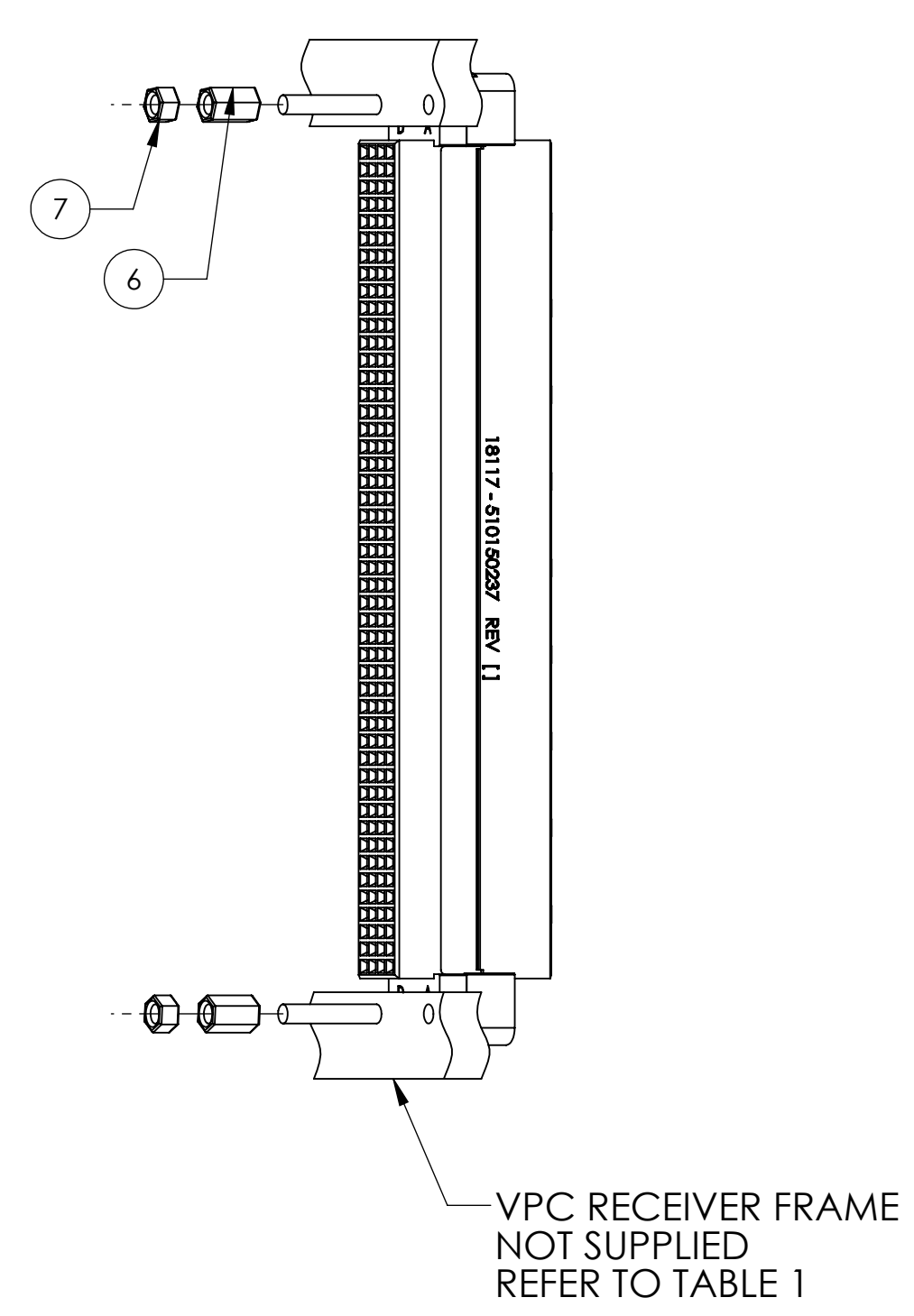
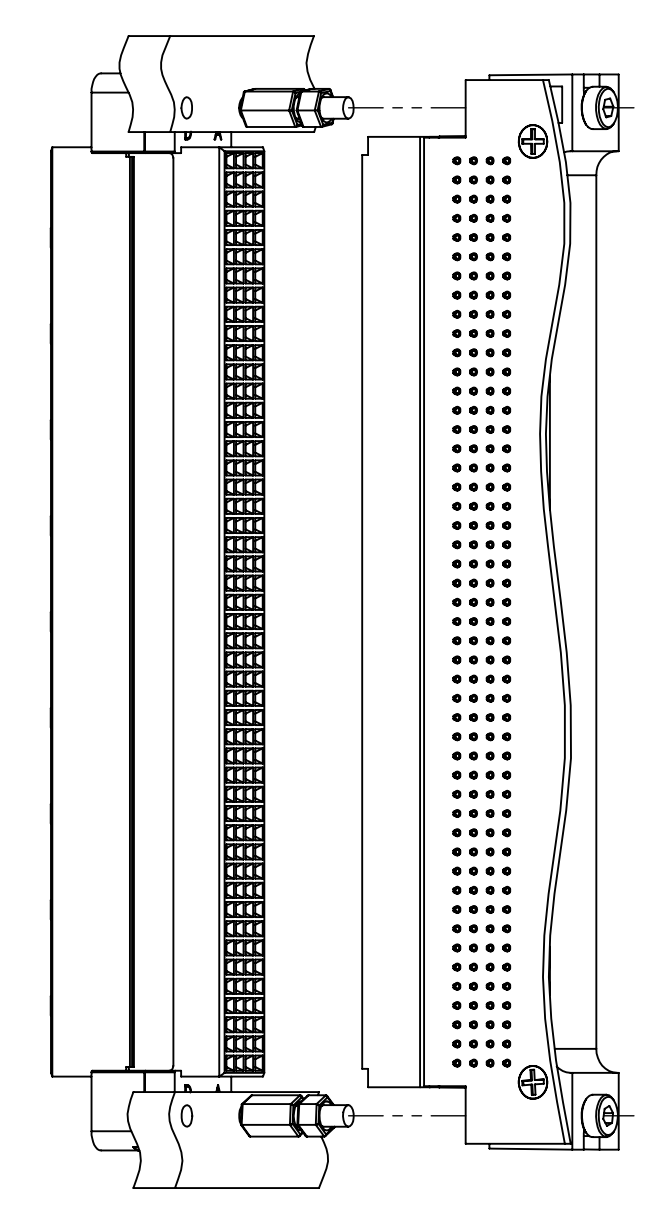

FIG 5



USERS MANUAL SKETCHES

TABLE 1

RECEIVER FRAME STYLE	RECEIVER FRAME THICKNESS	STAND-OFF CONFIGURATION	ITEMS TO BE USED
9025 9050 G12	0.545	1/8" STAND-OFF PER MNTG. SCREW	ITEM 7
90 & 2100 SERIES NON-PCB SUPPORT	0.365	5/16" STAND-OFF PER MNTG. SCREW	ITEM 6
GEMINI & 2100 SERIES with PCB SUPPORT	0.250	BOTH 1/8" AND 5/16" STAND-OFF PER MNTG. SCREW	ITEM 6 7

KIT PARTS LIST

ITEM NO.	QTY.	DESCRIPTION
7	2	4-40 x .13 THREADED STAND OFF
6	2	4-40 x .31 THREADED STAND OFF
5	2	SCR FH PHL 2-56 x .31 SST
4	2	Scr Sh Cp 4-40 x 1.25 SST
3	1	192 PIN RT ANG ML HDR
2	2	SPCL SDR SCR SOCKET HEAD
1	1	SHRD FOR CSTMR SPLD PCB ASM KIT

CUSTOMER DRAWING

VIRGINIA PANEL CORPORATION
WWW.VPC.COM
RCVR HDR/SHRD KIT
CSTMR SPLD PCB

NOTES:
1. FOR APPLICATION USE AND CARE INFORMATION CONSULT VPC USERS GUIDE @ WWW.VPC.COM

DIMENSIONS ARE SHOWN AS:	SIZE	CAGE CODE	DWG. NO.	REV
[MILLIMETERS]	D	18117	510109315	G
[INCHES]	SCALE: 1:1	510109315.6/13/03	SHEET	1 OF 1