

DO NOT SCALE DRAWING

THE INFORMATION CONTAINED HEREIN IS THE EXCLUSIVE PROPERTY OF VIRGINIA PANEL CORPORATION AND IS SUBMITTED FOR USE BY THE CUSTOMER ONLY. THE DATA SHALL NOT BE DUPLICATED, USED, OR DISCLOSED IN WHOLE OR IN PART FOR ANY PURPOSE OTHER THAN TO MAINTAIN THE EQUIPMENT PROVIDED. CONSULT WITH VIRGINIA PANEL CORPORATION ENGINEERING IF MORE DETAIL IS REQUIRED.

REVISIONS			
REV	DESCRIPTION	DATE	ENGR
C	ECN #5816	2/17/15	DMA

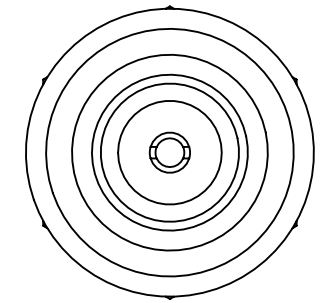
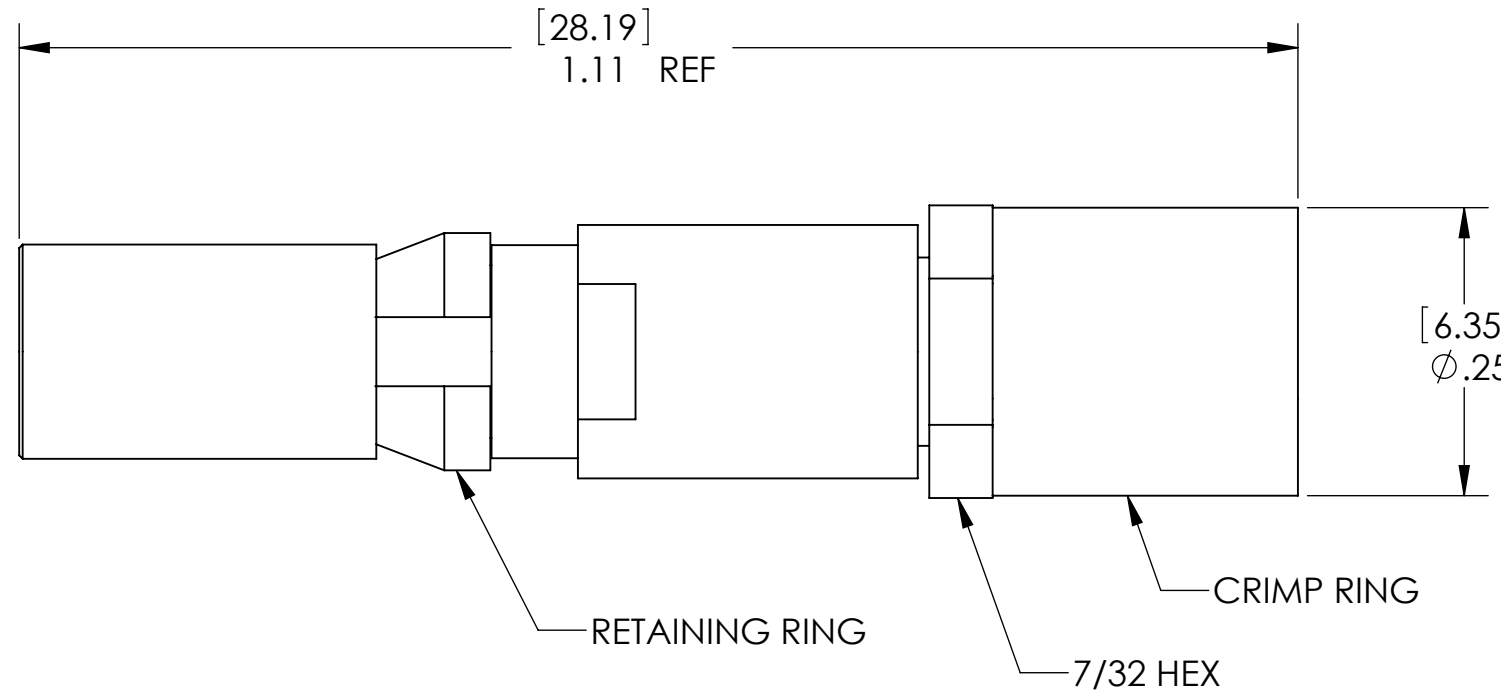
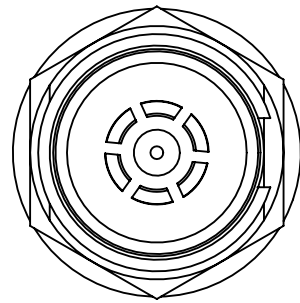

**ELECTRICAL SPECIFICATIONS:**

IMPEDANCE: 50 OHMS

BANDWIDTH: UP TO 26 GHz DC

RESISTANCE: CENTER 5 MILLIOHMS  
OUTER 3 MILLIOHMS

VSWR: 1.15 + .01 x (F) GHz

INSERTION LOSS: .06 x SQUARE ROOT (F) GHz dB

2. FOR USE WITH:  
STRIPFLEX 142B 26 GHZ  
M17/60-RG142 8 GHZ

1. FOR APPLICATION USE AND CARE INFORMATION CONSULT VPC USERS GUIDE @ WWW.VPC.COM  
**NOTES:**

COMPONENT	MATERIAL	FINISH
BODY	BRASS PER ASTM B 16	.000030" GOLD OVER NICKEL
CRIMP RING		
DIELECTRIC	VIRGIN TEFLON (PTFE) PER ASTM D 1710 & 1457	N/A
CENTER CONTACT	BERYLLIUM COPPER PER ASTM-B-197	.000030" GOLD OVER NICKEL
RETAINING RING	BERYLLIUM COPPER PER ASTM-B-196	NICKEL

**CUSTOMER DRAWING**

**VIRGINIA PANEL CORPORATION**  
WWW.VPC.COM

**CNT CX RCV 50OHM 20/26GHZ  
FOR RG142 & SF142B**

DIMENSIONS ARE SHOWN AS:		SIZE	CAGE CODE	DWG.NO.	REV
[MILLIMETERS]		B	18117	610102109	C
INCHES		SCALE: NONE		610102109	4/7/00
		SHEET		1 OF 1	