

DO NOT SCALE DRAWING

THE INFORMATION CONTAINED HEREIN IS THE EXCLUSIVE PROPERTY OF VIRGINIA PANEL CORPORATION AND IS SUBMITTED FOR USE BY THE CUSTOMER ONLY. THE DATA SHALL NOT BE DUPLICATED, USED, OR DISCLOSED IN WHOLE OR IN PART FOR ANY PURPOSE OTHER THAN TO MAINTAIN THE EQUIPMENT PROVIDED. CONSULT WITH VIRGINIA PANEL CORPORATION ENGINEERING IF MORE DETAIL IS REQUIRED.

REVISIONS			
REV	DESCRIPTION	DATE	ENGR
F	ECN 4825	9/9/13	S MARSHALL

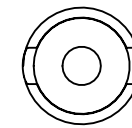
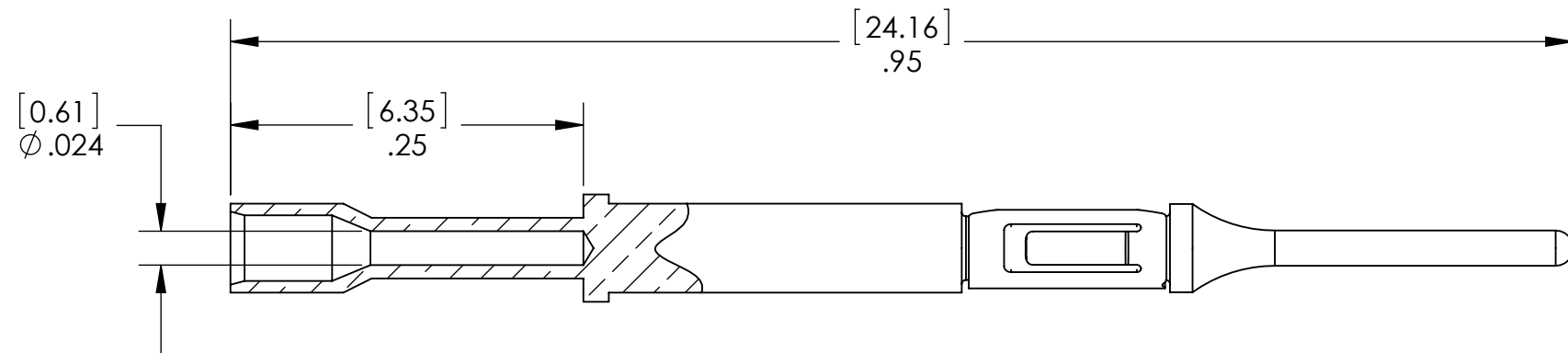
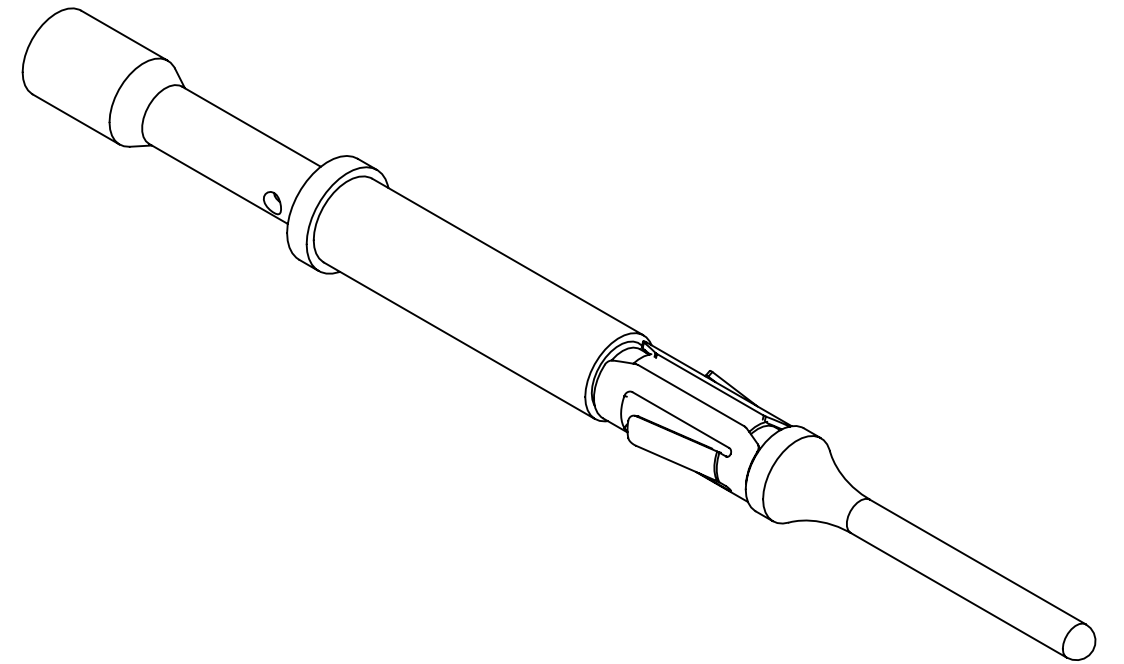

2. PHYSICAL CHARACTERISTICS:
 WEIHT - .0005 lbs.
 MATERIALS:
 CONTACT - BRASS ALLOY
 RETAINING RING - BeCu ALLOY
 CONTACT PLATING - 30 μ INCHS Au OVER 100 μ INCHES NICKEL

1. FOR APPLICATION USE AND CARE INFORMATION CONSULT VPC USERS GUIDE @ WWW.VPC.COM

NOTES:

RELATIVE CONNECTOR POSITIONS AND WIRE ROUTING ARE GENERIC AND MAY VARY WITH PINOUT

DIMENSIONS ARE SHOWN AS:
 [MILLIMETERS]
 INCHES

CUSTOMER DRAWING			
VIRGINIA PANEL CORPORATION WWW.VPC.COM			
CNT ML QPDL 26-28 Awg CMP ASM			
SIZE	CAGE CODE	DWG.NO.	REV
B	18117	610138112	F
SCALE: 8:1	610138112	11/26/02	SHEET 2 OF 2