



CRIMP TOOL GAUGING

INDEX ([CLICK TO NAVIGATE TO PAGE](#))

PAGE

2 [CRIMP TOOL GAUGING](#)

3 [GAUGE PIN SPECIFICATIONS](#)

*Please note that any printed or downloaded user manual may not reflect the most current information available. All content herein is subject to change.
For the most current information available, visit vpc.com.*

CRIMP TOOL GAUGING

CRIMP TOOLS PART # 910101102, -103, -118, -119

Please note that **a crimp tool cannot actually be calibrated** because it is not a measurement device. It can only be adjusted and verified to be in spec before use. The indicator window, located on top of the tool, is for **reference only** and can only approximate a setting. You must gauge the crimp tool to determine the actual setting.

GAUGING THE CRIMP TOOL

1. Squeeze the handles together completely and hold in this position. *Never close the indenter directly onto a gauge pin. This may damage the tool or render it inoperative.*
2. Select the proper gauge pin (gauge pin specifications are provided on the next page). Once the correct pin is selected, proceed as follows:
 1. While holding the indenter closed, insert the proper gauge pin through the indenter opening (**Figure B**). The gauge pin should slip fit through the indenter tips allowing for no free play.
 2. Should the size of indenter opening need to be adjusted, release the handles to the open position.
 3. Rotate the micro-crimp adjusting knob (clockwise to increase, counter-clockwise to decrease) to adjust the indenter opening
3. Repeat steps 1, 2, and 3 until correct opening size is set.
4. When the setting has been gauged and verified, release the tool handles to open. The tool is now ready for use.
5. Repeat the gauging procedure any time crimp settings need to be modified.

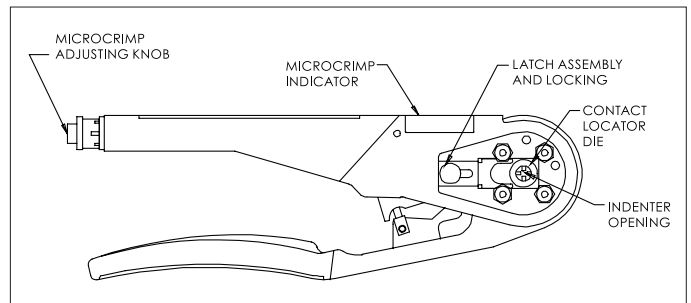

Figure A.

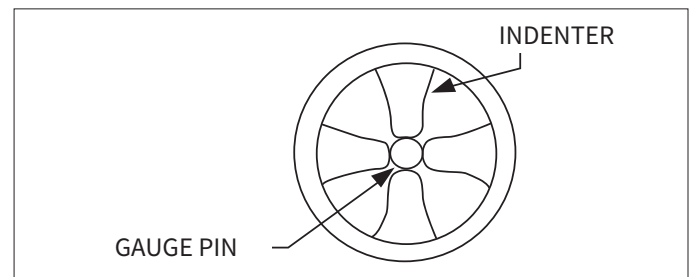

Figure B.



Indenter settings cannot be adjusted when the crimp tool is partially closed. Doing so will damage the crimp tool.

GAUGE PIN SPECIFICATIONS

PART # 910101104, - 108, -113, -115, -124, -131, -132; 910104139

Hex crimp tools may be gauged using the appropriate gauge pins as indicated below.

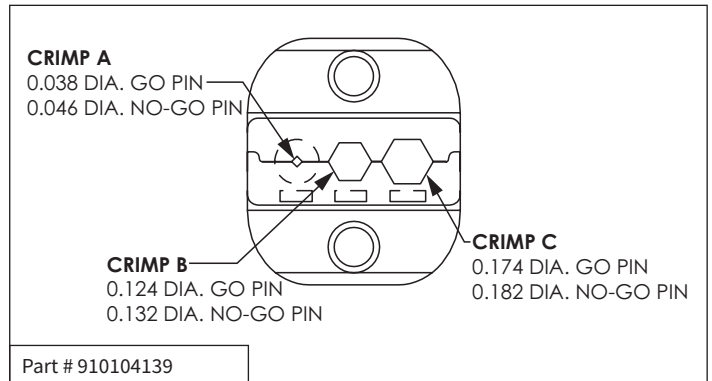
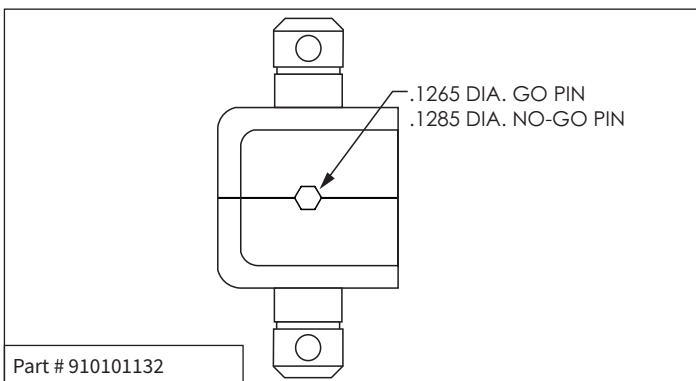
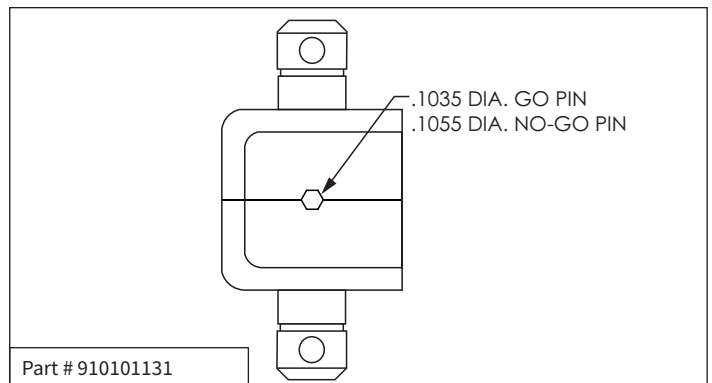
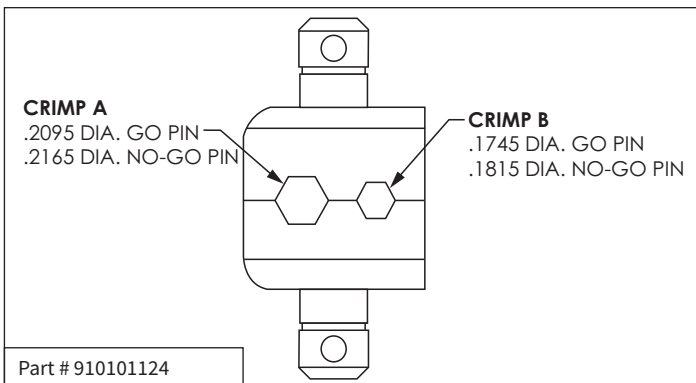
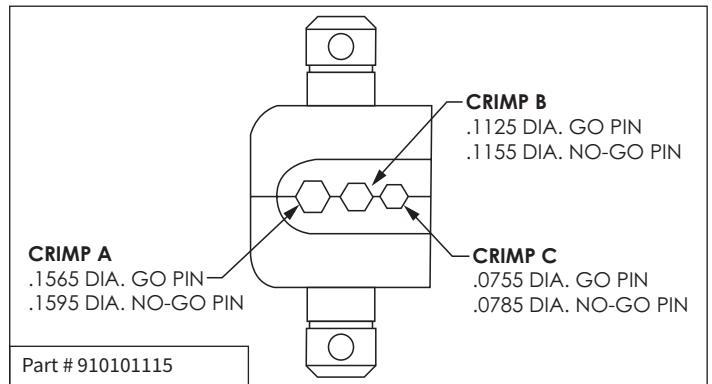
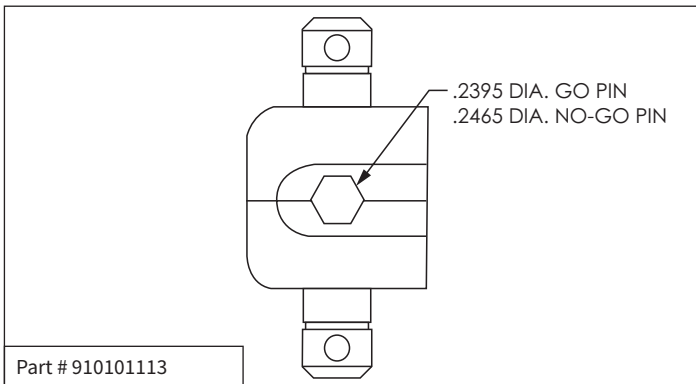
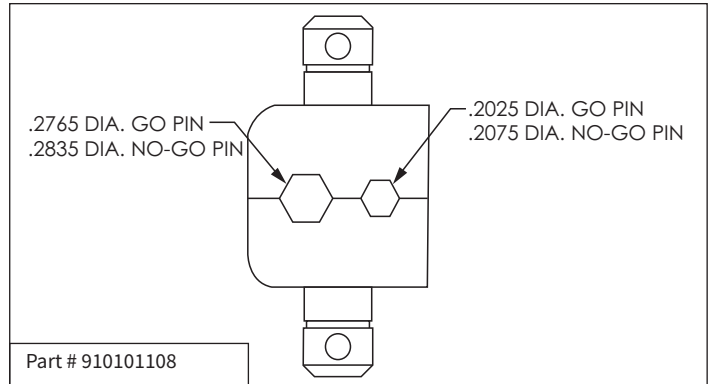
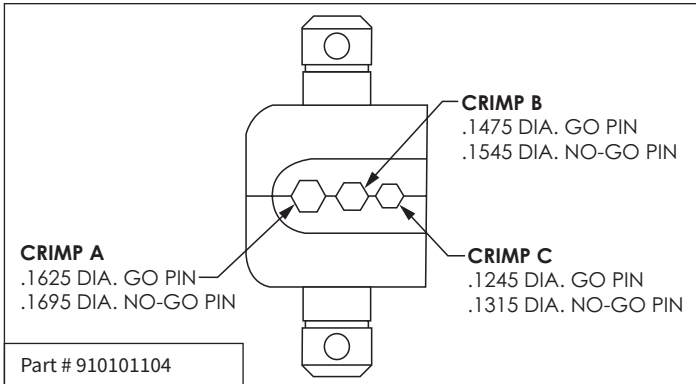

[RETURN TO INDEX](#)